

Suspended cables for crane power supply 250

Fittings for suspension cables 251

Flat cable system 253



Information

A simple and economical solution for movable power supplies for crane and transport installations, hoists, power tools, machines etc.

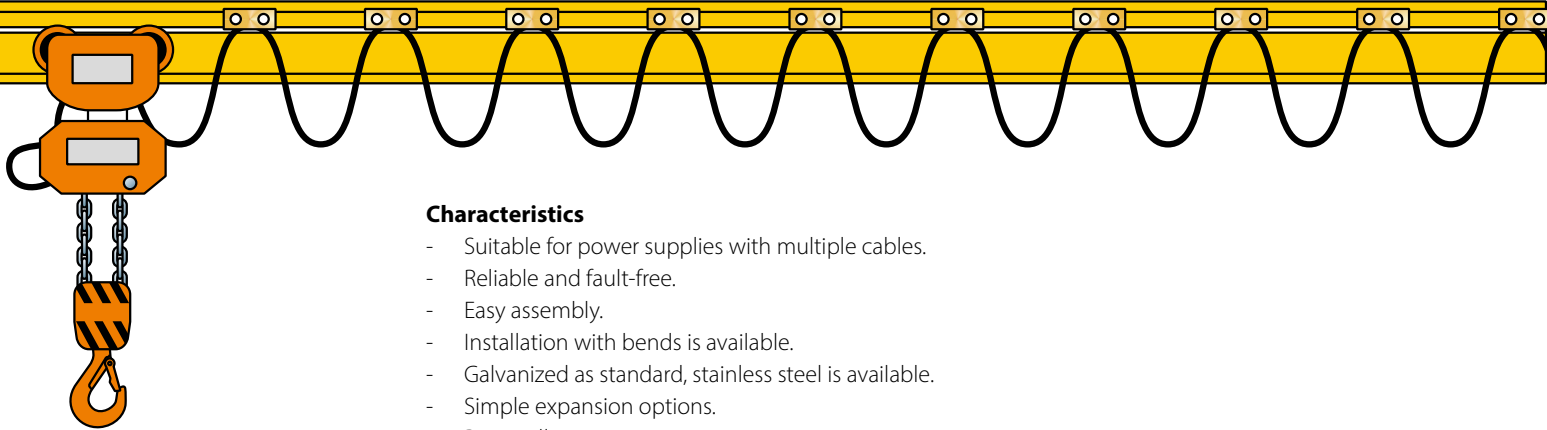

Characteristics

- Suitable for power supplies with multiple cables.
- Reliable and fault-free.
- Easy assembly.
- Installation with bends is available.
- Galvanized as standard, stainless steel is available.
- Simple expansion options.
- Practically no maintenance.

A complete installation consists of:

A | Running rails

Specify the profile size with the help of table 1.

- The total rail length consists of the track length (e.g. crane or lift track) plus the necessary overtravel (the length of the cable trolleys pushed together +15%. (see Picture 1).

B | Rail junction

Number of rail junctions:

The number of rails minus 1.

Example: Rail length = 12 m Number of rails = 4 (4x3m)
 $4 - 1 = 3$ braces

C | Ceiling or wall fixings

Determination of the number of ceiling or wall fixings:

- Along the running path in 1 to 2 intervals.
- Along the loading path in 0,5 to 1 m intervals.

D | Cable trolleys

For determination the numbers of cable trolleys multiply the allowable cable deflection by two and divide the length of track by the result obtained.

Example: Rail length = 12 m. Deflection = 0.6 m.
 $12 : (2 \times 0.6) = 12 : 1.2 = 10$ pcs incl. the tow trolley

E | Tow trolley

- 1 per installation

F | Connection clamp

- 1 per installation

G | Rail stop

- 1 per installation

Picture 1

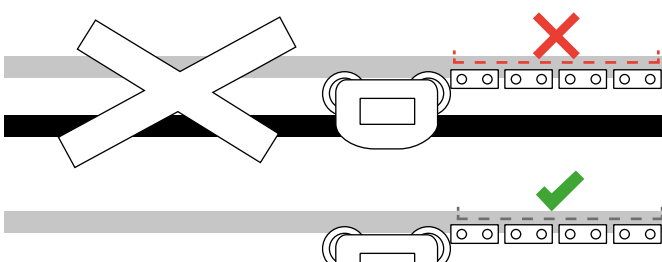
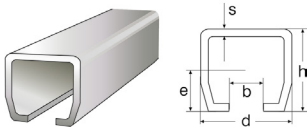

Table 1

Table for determining the correct rail profile:

Profile	Round cable diameter in mm					WLL cable trolley (kg)
	8 - 15	16 - 24	25 - 32	33 - 43	44 - 60	
PR400						50
PR300						30
PR100						10

C-rail



The standard length of C-rails for each profile sizes is appr. 6 m. Orders shorter than 18 m are delivered in 3 m lengths for an easier transport.

Type	B (mm)	D (mm)	E (mm)	H (mm)	S (mm)	Capacity per meter (kg)	Weight (kg/pcs/m)	ProductId
PR100	8	30	15,8	28	1,75	80	1.3	4001001
PR300	11	40	19,8	35	2,75	100	2.5	4001003
PR400	15	48.5	24,8	43.5	3,20	200	3.8	4001005

Rail extensions

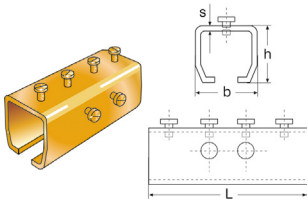

Type	B (mm)	H (mm)	L (mm)	S (mm)	Weight (kg/pcs/m)	ProductId
1103	38	36	85	3	0.3	4003001
1303	50	45	120	4	0.6	4003003
1403	60	54	150	4,5	1.0	4003005

Lateral fastener

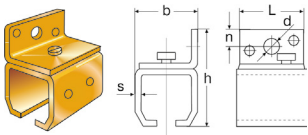

Type	B (mm)	D (mm)	H (mm)	L (mm)	N (mm)	S (mm)	Weight (kg/pcs/m)	ProductId
101	38	8	60	40	10	3	0.15	4005001
301	50	11	76	55	13	4	0.35	4005003
401	60	13	94	68	16,5	4,5	0.5	4005005

Top fastener

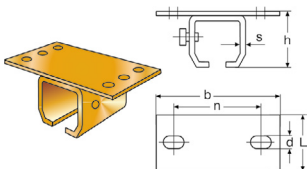

Type	B (mm)	D (mm)	H (mm)	L (mm)	N (mm)	S (mm)	Weight (kg/pcs/m)	ProductId
102	90	8	39	40	63 ± 3.5	3	0.2	4007001
302	115	11	50	55	80 ± 4.0	4	0.35	4007003
402	130	13	59	60	94 ± 4.0	4,5	0.5	4007005

C-Rail console



Included 2 clamps

Type	Length (mm)	Weight (kg/pcs/m)	ProductId
PR100-60CM	600	1.1	4038003
PR100-150CM	1500	1.9	4038004

Rail end stop

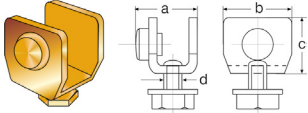

Type	For rail profile	A (mm)	B (mm)	C (mm)	D (mm)	Weight (kg/pcs/m)	ProductId
100P	100	25	26	23	M 8	0.05	4009001
300P	300	30	32	27	M10	0.09	4009003
400P	400	35	39	34	M10	0.12	4009005

Flat cable trolley

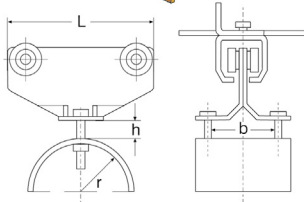
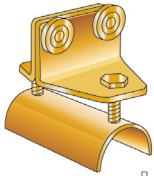

All cable cars are fitted with impact and water-resistant wheels; buffers at both sides.
 * Fitted with plastic wheels

Type	B (mm)	H (mm)	L (mm)	R (mm)	Cable holder (mm)	Weight (kg/pcs/m)	ProductId
157*	55	20	95	25	55x20	0.3	4011001
137	55	20	95	25	55x20	0.4	4012001
337	60	40	150	45	60x40	0.8	4011004
337	100	40	180	45	100x40	1.1	4011003
437	80	40	180	45	80x40	1.2	4011006
437	100	40	180	45	100x40	1.3	4011005

Flat cable clamps for C-rail

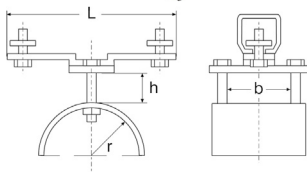
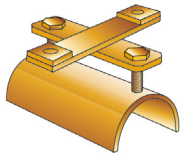

Type	B (mm)	H (mm)	L (mm)	R (mm)	Cable holder (mm)	Weight (kg/pcs/m)	ProductId
137E	55	20	107	25	55x20	0.3	4013001
337E	60	40	150	45	60x40	0.7	4013004
337E	100	40	150	45	100x40	0.8	4013003
437E	80	40	150	45	80x40	0.7	4013006
437E	100	40	150	45	100x40	0.8	4013005

Flat cable towing trolley

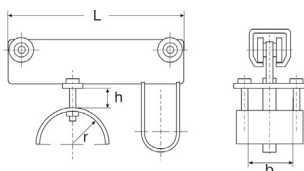
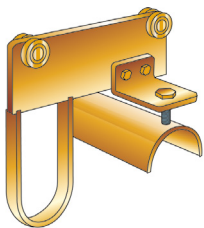

* Fitted with plastic wheels

Type	B (mm)	H (mm)	L (mm)	R (mm)	Cable holder (mm)	Weight (kg/pcs/m)	ProductId
157M*	55	20	165	25	55x20	0.5	4015001
137M	55	20	165	25	55x20	0.6	4016001
337M	60	40	260	45	60x40	1.4	4015004
337M	100	40	260	45	100x40	1.5	4015003
437M	80	40	260	45	80x40	1.7	4015006
437M	100	40	260	45	100x40	1.8	4015005

