

Overload limiters	240
Portal cranes	241
Column- and wall mounting cranes	243
Tripods	244
Traverse	245



HF overload limiter for wire ropes



Working principle: The deviation of the cable caused by the intervention of the sensor causes a tangential force that is proportional to the force exerted on the traction cable. In the event of an overload, a microswitch integrated in the sensor is pressed and stops the electric wire rope hoist.

Technical specifications

- Basic version: for cables from 4 to 35 mm.
- Measuring sensor: integrated microswitch.
- Installation: directly on the fixed part.
- Sensor material: aluminum of aviation quality.
- Surface treatment: colorless anodising.
- Calibration system: by micrometric screw.
- Switching voltage: max 220 VAC.
- Switching current: max 5 Amp.
- Accuracy: 5% of EM.
- Operating temperature: from -30 ° to + 80 ° C.
- Protection class: IP40.
- Maintenance: none.
- Connection: 3-wire electricity cable.
- Electrical output: contact plug.
- Length of cord: 2 meters, option 5 meters.

Application

- This overload protection is specifically designed for overhead cranes with multiple parts.

Option

- IP65.

CHECKLIST for request of the load limiter

- Capacity crane.
- Quantity of falls, minimal 2 fall.
- Diameter cable.
- Option IP65, standard IP40.

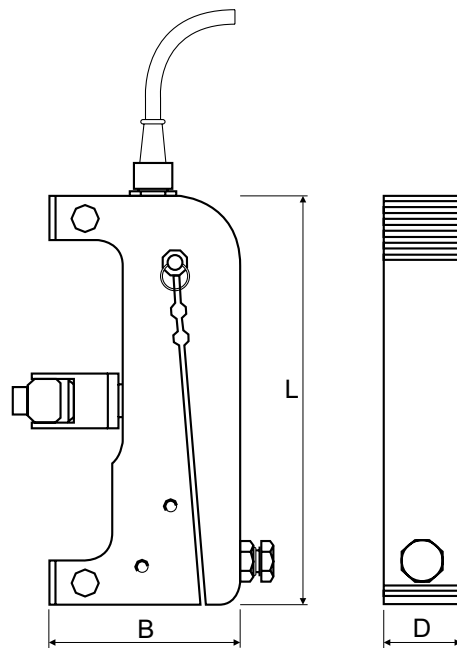

Type	S.W.L. (kg)	Cable diameter (mm)	B (mm)	D (mm)	L (mm)	Weight (kg)	ProductId
HF-0A	150 - 1600	4 - 10	59	28	120	0,4	4498000
HF-1A	250 - 3200	5 - 16	70	40	150	0.85	4498001
HF-2A	500 - 7000	17 - 25	98	50	200	2	4498002
HF-3A	1000 - 12000	24 - 35	138	60	280	5	4498003

PKA aluminum portal cranes



1500 kg

Properties

- Very short assembly and disassembly time of a few minutes.
- 3-part dismantlable, two columns and a support beam.
- Foldable columns for easy transport.
- Height adjustment, installation in low spaces is possible.
- Adjustable span by one, movable, columns.
- Very low own weight because the crane is made entirely of aluminum and plastic.

Applications

- If a non-permanent lifting point has to be created quickly and easily.
- Ideal for use when changing tools on machines or as an aid for repairs and replacement of parts, machines and pumps.



3000 kg

Standard delivery

- Trolley included.
- Exclusive hoist (see Chapter 1).

Option

- Wall console for 1 side.
- Mobile version (no load).
- Other versions on request.

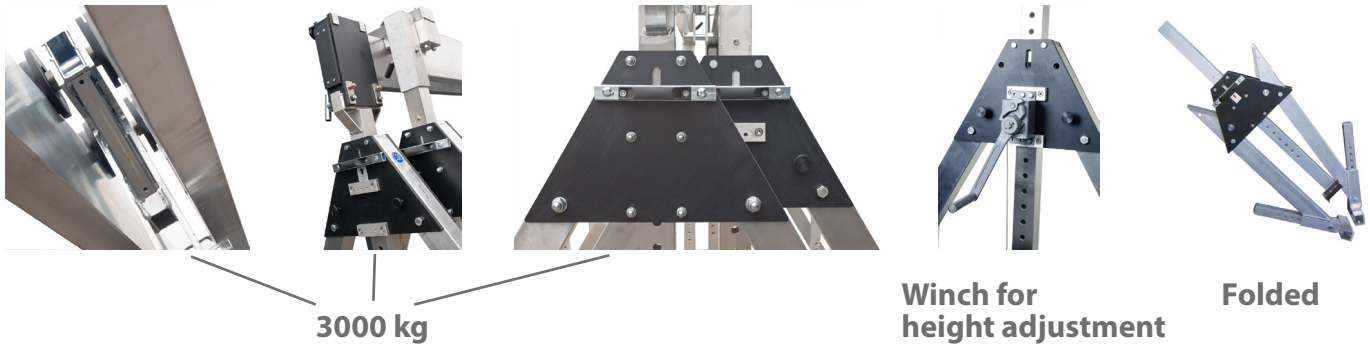

3000 kg

Winch for height adjustment

Folded

Type	S.W.L. (kg)	Height (mm)	Leg width (mm)	Beam length (mm)	Weight (kg)	ProductId
PKA-K-2	1500	1180 - 2100	1200	2000	98	3940008
PKA-K-3	1500	1180 - 2100	1200	3000	105	3940000
PKA-K-4	1500	1180 - 2100	1200	4000	115	3940001
PKA-M-2	1500	1680 - 3000	1710	2000	111	3940009
PKA-M-3	1500	1680 - 3000	1710	3000	121	3940002
PKA-M-4	1500	1680 - 3000	1710	4000	130	3940003
PKA-M-5	1500	1680 - 3000	1710	5000	140	3940007
PKA-G-2	1500	2230 - 4000	2290	2000	127	3940010
PKA-G-3	1500	2230 - 4000	2290	3000	138	3940004
PKA-G-4	1500	2230 - 4000	2290	4000	146	3940005
PKA-G-5	1500	2230 - 4000	2290	5000	156	3940006

PKAV Aluminium portal crane mobile

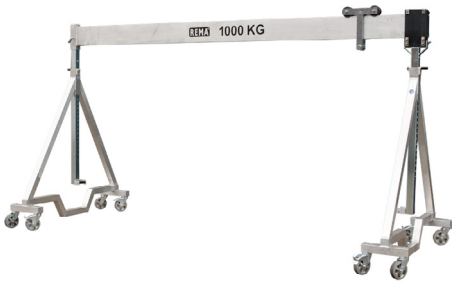

Properties

- Mobile with load.
- Very short assembly and disassembly time of a few minutes.
- 3-part dismountable, two columns and a support beam.
- Foldable columns for easy transport.
- Height adjustment, installation in low spaces is possible.
- Adjustable span by one, movable columns.
- Very low own weight because the crane is made entirely of aluminum and plastic.

Applications

- If a non-permanent lifting point has to be created quickly and easily.
- Ideal for use when changing tools on machines or as an aid for repairs and replacement of parts, machines and pumps.

Standard delivery

- Trolley included.
- Exclusive hoist (see Chapter 1).

Option

- Other designs on request

Type	S.W.L. (kg)	Height (mm)	Leg width (mm)	Beam length (mm)	Weight (kg)	ProductId
PKAV-K-3M	1000	1500-2000	1250	3000	127	3943001
PKAV-K-4M	1000	1500-2000	1250	4000	136	3943003
PKAV-M-3M	1000	2000-3000	1700	3000	149	3943005
PKAV-M-4M	1000	2000-3000	1700	4000	158	3943007
PKAV-M-5M	1000	2000-3000	1700	5000	168	3943008
PKAV-G-3M	1000	2250-3500	2000	3000	159	3943009
PKAV-G-4M	1000	2250-3500	2000	4000	168	3943011
PKAV-G-5M	1000	2250-3500	2000	5000	178	3943013

Column- and wall mounted jib cranes on request

Norm:

- EN 1993, EN 12100-1/2, EN 13157

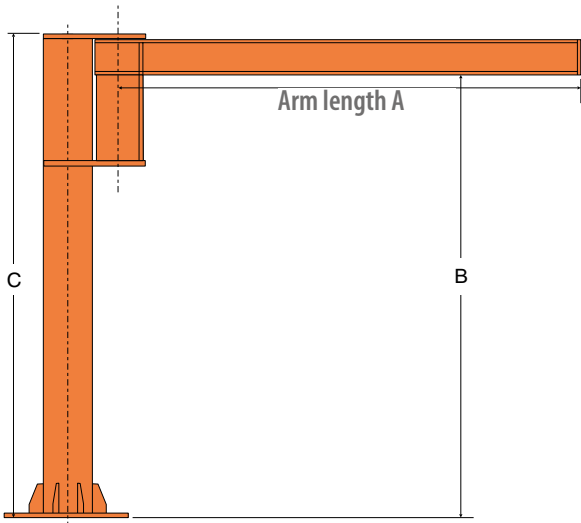

Type:
Column jib crane 270° degree slew.

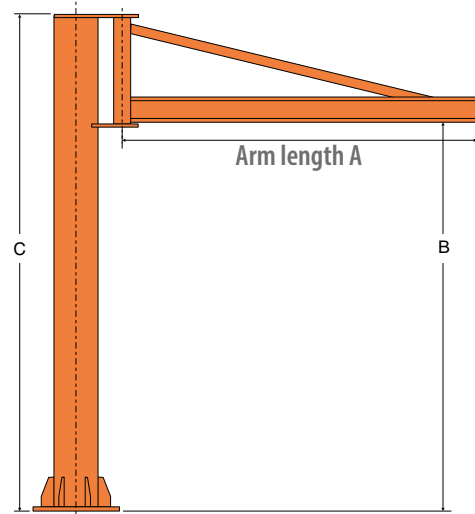

Type:
Column jib crane 270° degree slew.

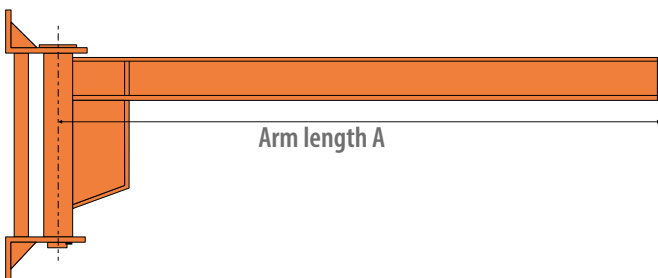

Type:
Wall mounted jib crane 180° slew.

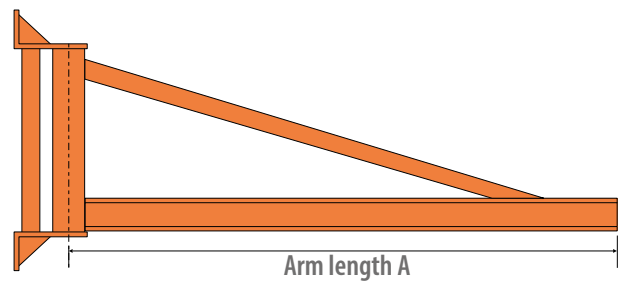

Type:
Wall mounted jib crane 180° slew.

D / DW aluminum tripods



REMA aluminum tripods are very light and easy to transport in any trunk because they can be retracted, so ideal for work.

Properties

- Light aluminum construction.
- Easy to transport through the telescopic version.
- Type D is equipped with suspension eye, height adjustment and pointed legs.
- Type DW is equipped with galvanized winch with load pressure brake, complete with steel cable and rotatable load hook, height adjustment and pointed legs.

Option

- Steel tripods on request.
- 3050025 flat footplates with anti-slip coating.
- 3050026 securing chain against leg slip.

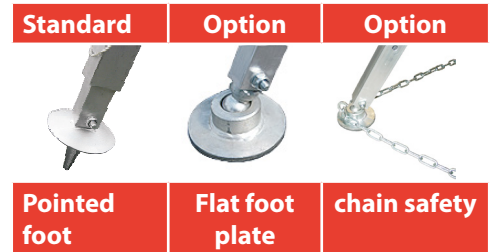

Type	S.W.L. (kg)	Leg length min / max (mm)	Height (mm)	maximum spread (mm)	Lifting height (m)	Weight (kg)	ProductId
D-250	250	1180 - 1880	940 - 1580	940 - 1500	-	10	3050001
D-500	500	1500 - 2500	1150 - 2050	1200 - 1950	-	17	3050005
D-503	500	1760 - 3000	1450 - 2630	1430 - 2390	-	20	3050002
D-1000	1000	1780 - 3000	1380 - 2540	1650 - 2350	-	27	3050004
D-1004	1000	2250 - 4000	1860 - 3440	1790 - 3070	-	36	3050006
DW-200	200	1180 - 1880	940 - 1580	950 - 1500	5	20	3050003
DW-500	500	2100 - 2500	1700 - 2100	1500 - 2000	5	35	3050007
DW-530	500	2400 - 3000	2000 - 2400	1900 - 2500	7	45	3050009
DW-1000	1000	2400 - 3000	1900 - 2400	1900 - 2500	7	45	3050011
DW-1040*	1000	2850 - 4000	2400 - 3400	2200 - 3000	7	69	3050013

Hoist traverse beams with 2 fixed hooks.



Properties

- Surface finish: zinc phosphate primer RAL 2004 (orange).
- Capacity range labelling.
- Black-and-yellow safety markings at beam ends.
- Hooks equipped with safety latches.
- High quality steel hooks grade 10.

Option

- Sandblasting and painting in every RAL color.
- Higher load capacity and bigger dimensions on request.

Norm:

- EN12100-1/2, EN13155, EN1677, PAS1065

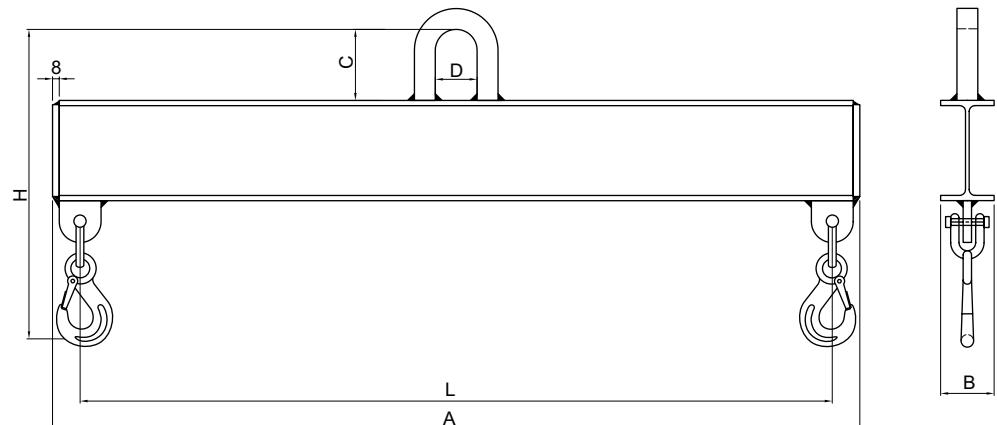

Type	S.W.L. (kg)	A (mm)	B1 (mm)	C (mm)	D (mm)	H (mm)	L (mm)	Weight (kg)	ProductId
TRA-VA-1000-1M	1000	1070	65	85	55	380	1000	13	3962001
TRA-VA-1000-1.6M	1000	1670	65	85	55	400	1600	22	3962003
TRA-VA-1000-2.5M	1000	2570	75	85	55	420	2500	38	3962005
TRA-VA-1000-3,15M	1000	3220	85	85	55	420	3150	57	3962007
TRA-VA-1600-1,6M	1600	1690	75	85	55	480	1600	27	3962009
TRA-VA-1600-2,5M	1600	2590	85	85	55	500	2500	55	3962011
TRA-VA-1600-3,15M	1600	3240	90	85	55	520	3150	78	3962013
TRA-VA-1600-4M	1600	4090	100	85	55	520	4000	98	3962015
TRA-VA-2500-2,5M	2500	2590	90	85	70	540	2500	68	3962017
TRA-VA-2500-3,15M	2500	3240	100	85	70	560	3150	111	3962019
TRA-VA-2500-4M	2500	4090	110	85	70	580	4000	138	3962021
TRA-VA-2500-5M	2500	5090	135	85	70	600	5000	198	3962023

Hoist traverse beams with 2 adjustable hooks.



Properties

- Surface finish: zinc phosphate primer RAL 2004 (orange).
- Capacity range labelling.
- Black-and-yellow safety markings at beam ends.
- Hooks equipped with safety latches.
- High quality steel hooks grade 10.

Option

- Sandblasting and painting in every RAL color.
- Higher load capacity and bigger dimensions on request.

Norm:

- EN12100-1/2, EN13155, EN1677, PAS1065

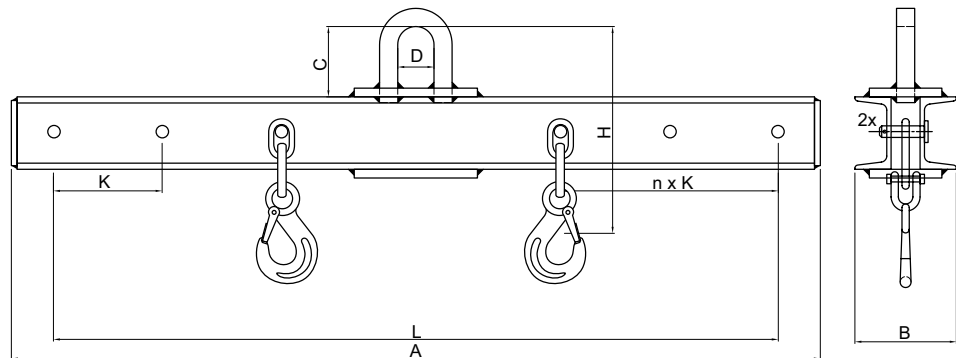

Type	S.W.L. (kg)	B2 (mm)	C (mm)	D (mm)	H (mm)	L (mm)	n x k (mm)	Weight (kg)	ProductId
TRA-VE-1000-1M	1000	140	85	55	380	1000	2 x 150	30	3962041
TRA-VE-1000-1,6M	1000	140	85	55	400	1600	3 x 150	40	3962043
TRA-VE-1000-2,5M	1000	160	85	55	420	2500	5 x 150	67	3962045
TRA-VE-1000-3,15M	1000	170	85	55	420	3150	7 x 150	100	3962047
TRA-VE-1600-1,6M	1600	150	85	55	480	1600	2 x 200	48	3962049
TRA-VE-1600-2,5M	1600	170	85	55	500	2500	4 x 200	83	3962051
TRA-VE-1600-3,15M	1600	190	85	55	520	3150	5 x 200	120	3962053
TRA-VE-1600-4M	1600	200	85	55	520	4000	7 x 200	171	3962055
TRA-VE-2500-2,5M	2500	180	85	70	540	2500	4 x 200	115	3962057
TRA-VE-2500-3,15M	2500	200	85	70	560	3150	5 x 200	140	3962059
TRA-VE-2500-4M	2500	220	85	70	580	4000	7 x 200	202	3962061
TRA-VE-2500-5M	2500	240	85	70	600	5000	8 x 200	284	3962063

BBJ cross traverses



Properties

- 4 welded hooks (Grade 8) for stable suspension.
- Surface finish: RAL 2004 (orange).
- Capacity range labelling.
- Black-and-yellow safety markings at beam ends.
- Hooks equipped with safety latches.

Norm:

- EN12100-1/2, EN13155, EN1677

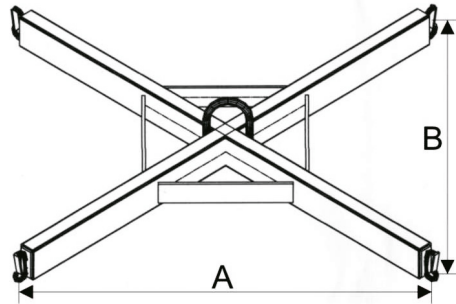

Type	S.W.L. (kg)	A (mm)	B (mm)	Construction height (mm)	Lifting eye diameter (mm)	Weight (kg)	ProductId
BBJ-1.0	1000	800	800	150	25	21.0	3963010
BBJ-1.5	1500	800	800	150	25	24.0	3963015
BBJ-2.0	2000	800	800	200	25	29.0	3963020
BBJ-2.5	2500	800	800	200	25	31.0	3963025

BBJR cross traverses



Properties

- 4 hooks for stable suspension.
- Material: Stainless steel AISI 316.
- Capacity range labelling.
- Hooks equipped with safety latches.

Norm:

- EN12100-1/2, EN13155, EN1677

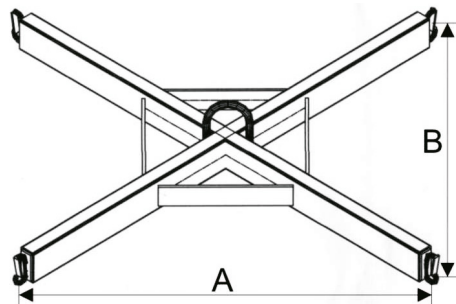

Type	S.W.L. (kg)	A (mm)	B (mm)	Construction height (mm)	Lifting eye diameter (mm)	Weight (kg)	ProductId
BBJR-1.0	1000	800	800	215	25	25.0	3963110
BBJR-1.5	1500	800	800	230	25	30.0	3963115

HTH fork-lift hook



Properties

- Make a mobile crane of your fork-lift truck.
- Screw clamps on the forks for safety.
- Included swivel hook (Grade 8).

Norm:

- EN12100-1/2, EN13155, EN1677, EN13889

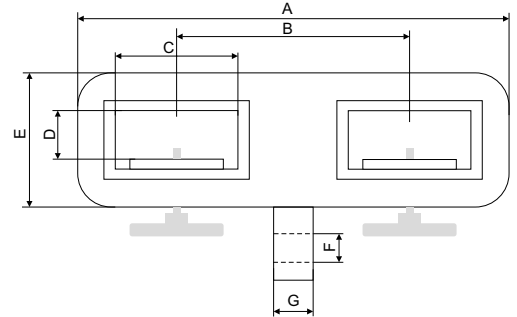

IMPORTANT

- Do not exceed the capacity of the fork-lift truck.
- Pay attention to the load's centre of gravity.
- Prevent wobbling of the load during transport.

Type	S.W.L. (kg)	Dimensions fork opening (mm)	Weight (kg)	ProductId
HTH-1000	1000	125 x 50	14	3963501
HTH-2500	2500	135 x 55	25	3963503
HTH-5000	5000	145 x 55	46	3963505

Type	A (mm)	B (mm)	C (mm)	D (mm)	E (mm)	F (mm)	G (mm)
HTH-1000	437	255	135	55	116	24	16
HTH-2500	657	450	145	60	140	27	20
HTH-5000	600	420	180	100	175		

Forklift crane arm HKA



Properties

- 10 positions extendable.
- 4 positions adjustable.
- Equipped with lock chain.
- Equipped with fork insertion and lock chain.
- Color orange.

Technical specifications

- Fork inserts 2000 kg = 180 x 80 mm
- Fork inserts 3000 kg = 225 x 80 mm

Application

- Ideal for all kinds of disassembly and assembly work.

Norm:

- EN12100-1/2, EN13155, EN1677

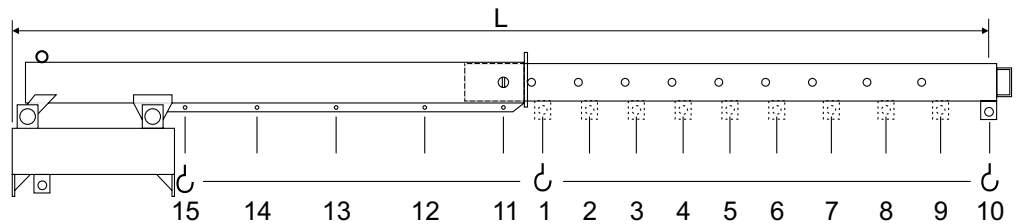

Type	S.W.L. (kg)	Length (mm)	Breedte (mm)	Weight (kg)	ProductId
HKA-2.0	2000	2165-3740	520	175	3965002
HKA-3.0	3000	2165-3740	643	280	3965003