

Comparison list lever hoist	18
REMA Elephant YA ratchet hoist	19
REMA Select 2 OD ratchet hoist	23
REMA X-Line ratchet hoist	24



**Ratchet hoist selection chart**



**REMA YA**

The no. 1 amongst the ratchet hoists. Top quality and easy to use.

**Main features**

Suitable for very intensive use in the offshore industry and heavy industry.

**1.000 kg - 9.000 kg**  
**Page 19**



**REMA YA mini ratchet hoist**

Same as YA, but very compact and weighing just 2 kg for 1.5 meters lifting height.

**Main features**

Due to its very low weight, ideal for every toolbox and/or service vehicle.

**250 kg**  
**Page 20**

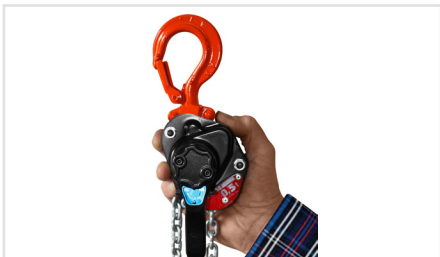

**REMA YAM**

Same as YA, except it is extremely compact with a gear transmission in 500 kg version.

**Main features**

Due to its extremely low weight of 2.8 kg, ideal for every toolbox and/or service vehicle.

**500 kg**  
**Page 21**



**REMA YAS**

Same as YA, except it is fitted with shipyard hooks.

**Main features**

For pulling in all directions in shipbuilding.

**1.600 kg and 3.200 kg**  
**Page 22**

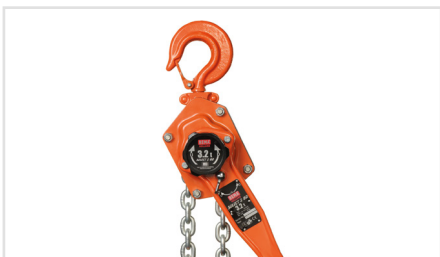

**REMA S2-OD**

With innovative overload protection for safely lowering the load in the event of overloading.

**Main features**

Safe working. Protects both the hoist and the structure against undesirable overloading.

**250 kg - 9.000 kg**  
**Page 23**



**REMA X-line**

Produced to the same quality requirements as the Select 2-OD.

**Main features**

Equivalent to the Select 2-OD, but without the overload protection.

**250 kg - 9,000 kg**  
**Page 24**



## REMA YA ratchet hoist



Model REMA YA ratchet hoist is a robust ratchet lever hoist suitable for lifting, pulling, tensioning and lashing in any directions.

### Properties

- Grade 10 Galvanized load chain with high tensile strength (EN 818/7).
- Compact construction and very low self-weight.
- Reliable self-locked brake which will retain the load at every required height.
- Hooks provided with safety latches.
- In case of overload, the hooks will gradually bend and do not suddenly break off.
- Patented guide for the load chain.
- A double spring on each catch for additional safety.

### Standard delivery

- 1,5 m lifting height (max distance between top and bottom hookpositions).

### Option

- Available in other lifting heights.

### Norm:

- EN12100-1/2, EN13157, EN818-7

1.0-3.2 t

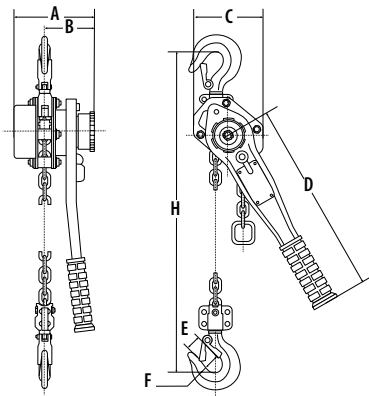

6.3 t

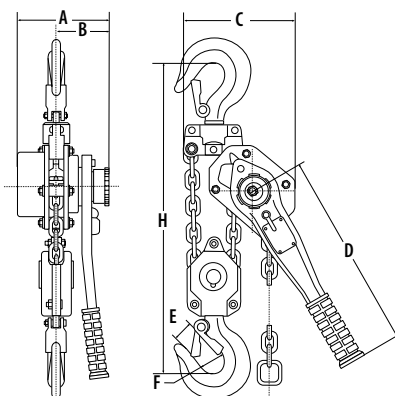

9.0 t

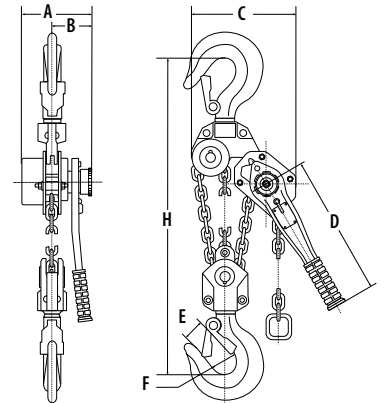

Type	WLL (kg)	Hand force max. (kg)	Load chain (mm)	Number of falls	Construction height (mm)	Weight (kg)	ProductId
YA-1000KG	1.000	37	5,6 x 17,1	1	312	6.2	0208003
YA-1600KG	1.600	37	7,1 x 21,0	1	352	9.2	0208005
YA-3200KG	3.200	37	9,0 x 27,2	1	420	15.5	0208007
YA-6300KG	6.300	38	9,0 x 27,2	2	564	26.5	0208009
YA-9000KG	9.000	39	9,0 x 27,2	3	589	42.0	0208011

Type	A (mm)	B (mm)	C (mm)	D (mm)	E (mm)	F (mm)	H (mm)
YA-1000KG	144	91	122	268	28	43	312
YA-1600KG	162	99	136	310	29	43	352
YA-3200KG	186.5	104	180	310	36	53	420
YA-6300KG	186.5	104	235	310	47	70	564
YA-9000KG	186.5	104	300	310	73	85	689

## REMA YA mini ratchet hoist



The REMA YA ratchet hoist is an extremely robust ratchet hoist for hoisting, pulling, tensioning and lashing in all directions. With one simple action the ratchet hoist can be set in its freewheel.

### Properties

- Very low self weight, compact dimensions.
- The rotatable top and bottom hook are provided with safety latches.
- In case of overload, the hooks will gradually bend and do not suddenly break off.
- Self locked brake that holds the load at any desired height.
- Freewheel is possible in unloaded condition.
- Freewheel by one simple action.
- The hoist is fitted with a rubber anti-slip handle.
- Galvanized load chain (Grade 10).

### Standard delivery

- 1,5 m lifting height (max distance between top and bottom hookpositions).

### Option

- Available in other lifting heights.

### Norm:

- EN12100-1/2, EN13157, EN818-7

**Only weighs  
2 kg with  
1,5 meter Lifting**

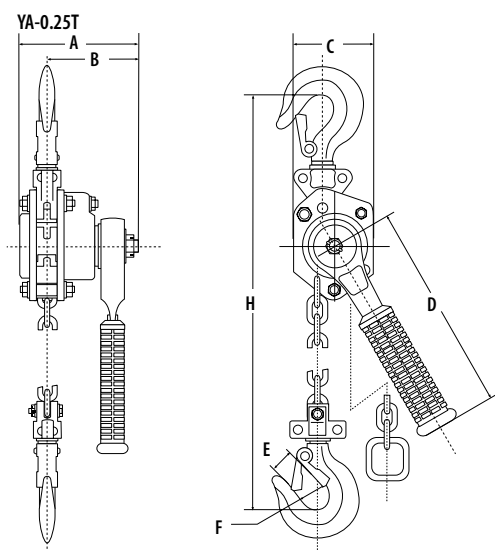

Type	WLL (kg)	Hand force max. (kg)	Load chain (mm)	Number of falls	Construction height (mm)	Weight (kg)	ProductId
YA-250KG	250	30	4.0 x 12.0	1	235	2.0	0208000

Type	A (mm)	B (mm)	C (mm)	D (mm)	E (mm)	F (mm)	H (mm)
YA-250KG	91	70	60	155	23	31	235

## REMA YAM ratchet hoist



The REMA YAM mini ratchet hoist is compact and a very low own weight. The required manual effort on the short handle (180 mm) remains low because the YAM is equipped with a gear transmission. The ideal tool for assembly work such as hoisting, pulling and tensioning.

### Properties:

- Very low self weight (2,8 kg), compact.
- Hooks equipped with safety latches.
- Self locked brake holds the load at any desired height.
- Freewheel is possible in unloaded condition, by 1 operation.
- Hoist fitted with rubber anti-slip handle.
- In case of overload, the hooks will gradually bend and do not suddenly break off.
- Galvanized load chain Grade 10.

### Standard delivery:

- 1,5 m lifting height (max. distance between top & bottom hooks).

### Option:

- Available in other lifting heights.

### Norm:

- EN12100-1/2, EN13157, EN818-7

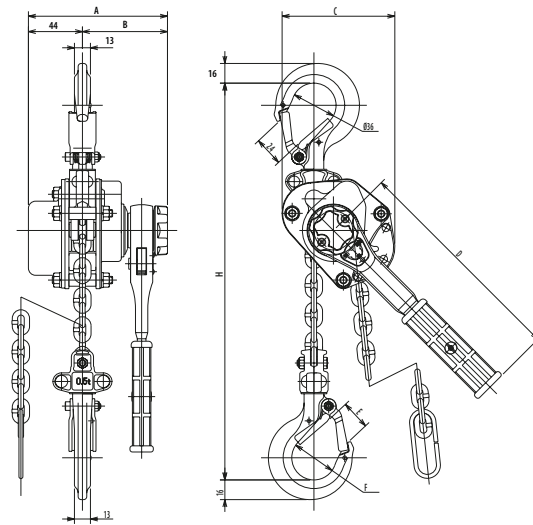

Only weighs  
2,8 kg with  
1,5 meter Lifting

Type	WLL (kg)	Hand force max. (kg)	Load chain (mm)	Number of falls	Construction height (mm)	Weight (kg)	productid
YAM-500KG	500	35	4.3 x 12	1	240	2.8	0208002

Type	A (mm)	B (mm)	C (mm)	D (mm)	E (mm)	F (mm)	H (mm)
YAM-500KG	113	69	92	180	24	36	240

## REMA YAS ratchet hoist



The REMA YAS Puller is an extremely robust ratchet hoist for pulling in all directions. With one simple action the ratchet hoist can be set in its freewheel.

### Fitted with shipyard hooks.

#### Properties

- Technical specifications see YA ratchet hoist.
- Equipped with shipyard hooks, only suitable for pulling.
- Can be used to pull steel sections together.

#### Standard delivery

- 1.5 m working length (maximum distance between top and bottom hook).

#### Option

- Longer chain length are available.

#### Norm:

- EN12100-1/2, EN13157, EN818-7

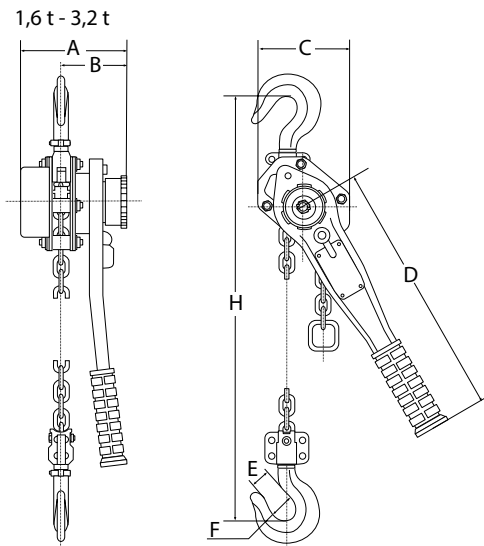

Type	WLL (kg)	Hand force max. (kg)	Load chain (mm)	Number of falls	Construction height (mm)	Weight (kg)	ProductId
YAS-1600KG-SW	1.600	37	7,1 x 21,0	1	352	9.2	0208006
YAS-3200KG-SW	3.200	37	9,0 x 27,2	1	420	15.5	0208008

Type	A (mm)	B (mm)	C (mm)	D (mm)	E (mm)	F (mm)	H (mm)
YAS-1600KG-SW	162	99	136	310	34	45	352
YAS-3200KG-SW	186,5	104	180	310	47	57	420

**REMA Select 2 OD ratchet hoist (OD is with overload device)**

The REMA Select 2 OD ratchet hoist with serial built-in overload device, except 250 kg \*, for safe working during lifting, pulling, tensioning or lashing.



**Properties**

- The innovative overload device ensures safer operation of the hoist.
- Overload device system makes it possible to lower the load in a controlled way.
- Overload device prevents dangerous overloading of the hoist and construction.
- Low leverage at full load due to bearing.
- Equipped with a double pawl system.
- Brake fitted with asbestos-free friction discs.
- Load chain wheel is made of precision and wear-resistant alloy steel.
- Freewheel is possible in unloaded condition.
- Top and bottom swivel hook with robust safety latches.
- In case of overload, the hooks will gradually bend and do not suddenly break off.
- Galvanized load chain Grade 8.
- Lever with REMA rubber anti-slip handle.

**Standard delivery**

- 1,5 m lifting height (max distance between top and bottom hook).
- 250 kg without overload device.

**Option**

- Available in other lifting heights.

**Norm:**

- EN12100-1/2, EN13157, EN818-7



0.25 t

0.5 t - 3.0 t

6.0 t

9.0 t

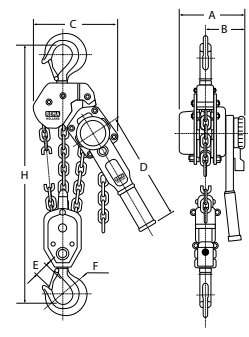
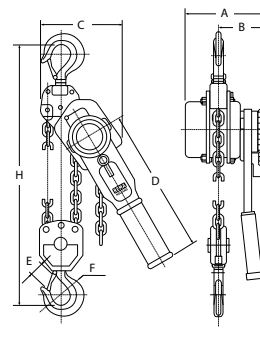
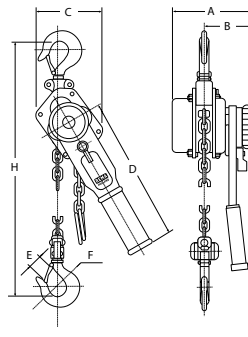
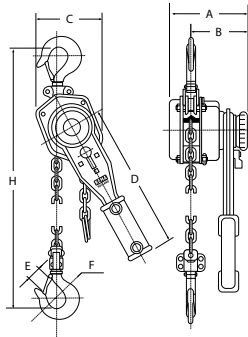

Type	WLL (kg)	Hand force max. (kg)	Load chain (mm)	Number of falls	Construction height (mm)	Weight (kg)	ProductId
S2-250KG*	250	28.2	4.0 x 12.0	1	235	2.5	0220000
S2OD-500KG	500	24.8	5.0 x 15.0	1	310	5.5	0220001
S2OD-800KG	800	26.5	5.6 x 17.0	1	340	6.5	0220003
S2OD-1600KG	1.600	29.5	7,1 x 21,0	1	400	10.2	0220005
S2OD-3200KG	3.200	33.5	10.0 x 28.0	1	520	22.0	0220007
S2OD-6300KG	6.300	37.0	10.0 x 28.0	2	640	34.0	0220009
S2OD-9000KG	9.000	42.0	10.0 x 28.0	3	730	45.0	0220011

\* = without overload protection.

Type	A (mm)	B (mm)	C (mm)	D (mm)	E (mm)	F (mm)	H (mm)
S2-250KG*	100	70	86	163	20	31	235
S2OD-500KG	150	90	118	253	22	32	310
S2OD-800KG	158	98	132	273	26	36	340
S2OD-1600KG	185	111	145	378	29	43	400
S2OD-3200KG	212	124	198	418	37	50	520
S2OD-6300KG	212	124	230	418	43	53	640
S2OD-9000KG	212	124	338	418	44	67	730

## REMA X-Line ratchet hoist



The REMA X-Line is a competitive ratchet hoist for safe and reliable operation during hoisting, pulling, tensioning or lashing.

### Properties

- Low effort at full load.
- Increased operational safety due to double pawl system.
- Brake with asbestos free friction discs.
- Freewheel in unloaded condition.
- Load chain wheel is made of wear-resistant alloy steel.
- Top and bottom hook have safety latches.
- In case of overload, the hooks will gradually bend and do not suddenly break off.
- Galvanized load chain (Grade 8).

### Standard delivery

- 1,5 m lifting height (max distance between top and bottom hook).

### Option

- Available in other lifting heights.

### Norm:

- EN12100-1/2, EN13157, EN818-7

0.25t

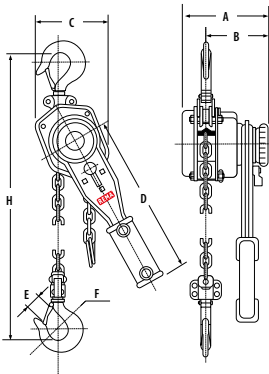

0.5t-3.2t

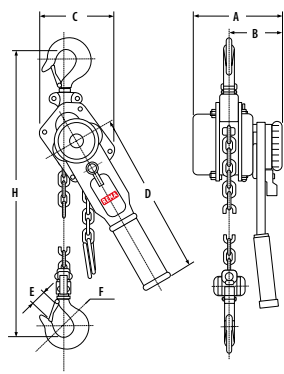

6.3t

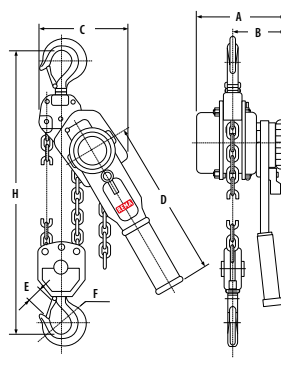

9.0t

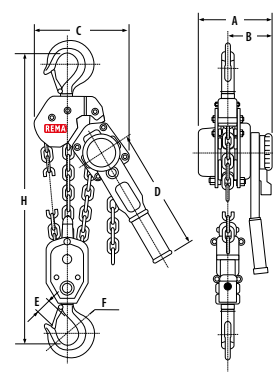

Type	WLL (kg)	Hand force max. (kg)	Load chain (mm)	Number of falls	Construction height (mm)	Weight (kg)	ProductId
X-LH025/250KG	250	28.2	4.0 x 12.0	1	235	2.5	0270000
X-LH050/500KG	500	24.8	5.0 x 15.0	1	310	5.5	0270001
X-LH080/800KG	800	26.5	5.6 x 17.0	1	340	6.5	0270003
X-LH16/1600KG	1600	29.5	7,1 x 21,0	1	400	10.2	0270005
X-LH32/3200KG	3200	33.5	10.0 x 28.0	1	520	22.0	0270007
X-LH63/6300KG	6300	37.0	10.0 x 28.0	2	640	34.0	0270009
X-LH90/9000KG	9000	42.0	10.0 x 28.0	3	730	45.0	0270011

Type	A (mm)	B (mm)	C (mm)	D (mm)	E (mm)	F (mm)	H (mm)
X-LH025/250KG	100	70	86	163	20	31	235
X-LH050/500KG	150	90	118	253	22	32	310
X-LH080/800KG	158	98	132	273	26	36	340
X-LH16/1600KG	185	111	145	378	29	43	400
X-LH32/3200KG	212	124	198	418	37	50	520
X-LH63/6300KG	212	124	230	418	43	53	640
X-LH90/9000KG	212	124	338	418	44	67	730