

Lifting clamps info	138
Vertical plate clamp	139
Horizontal plate clamp	148
Spindle clamps	152
Beam lifting clamps	154
Bulb-, profil-clamps	155
Rail lifting clamps	157
Pallet pullers	159

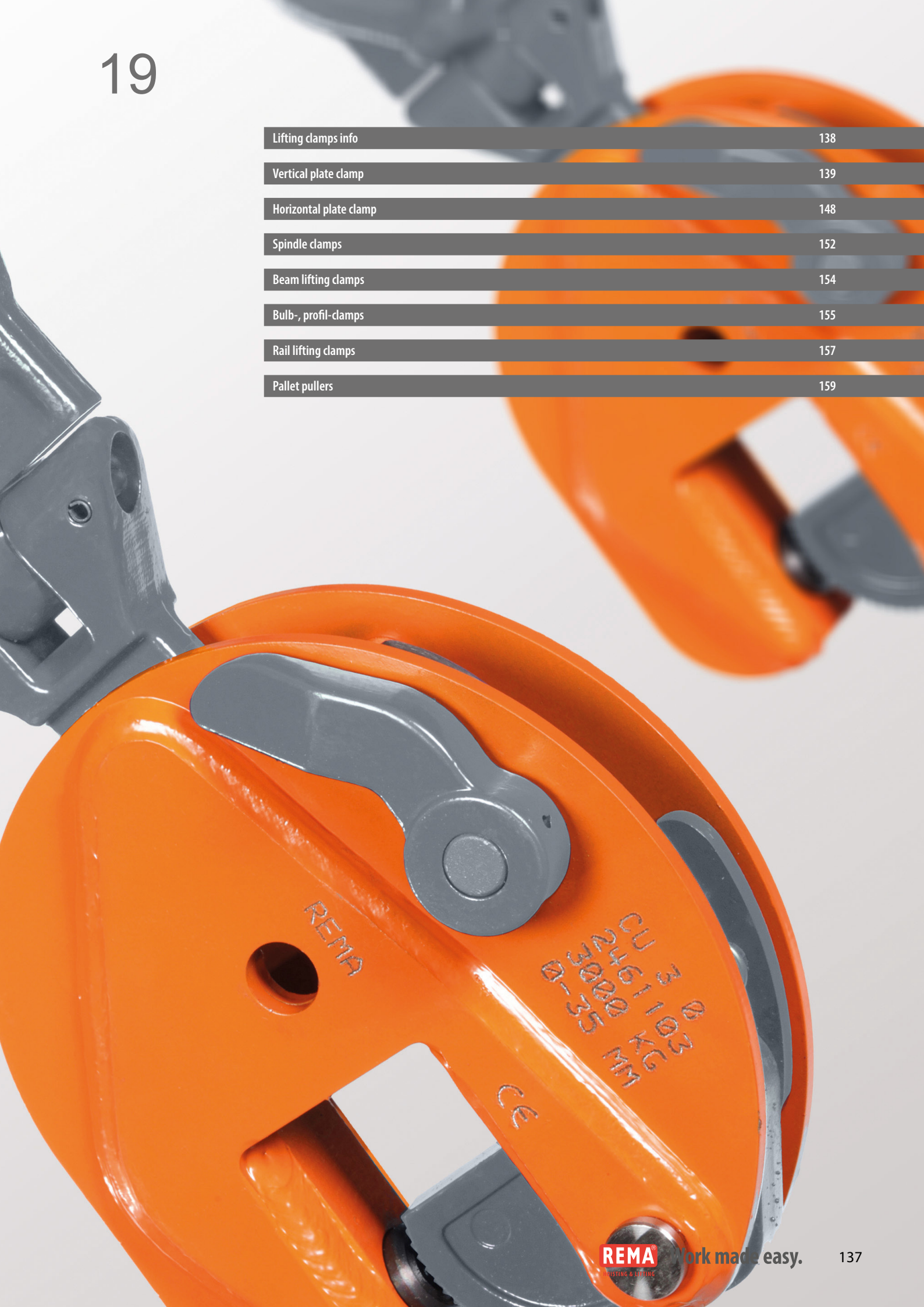

REMA

CE

REMA  
 31003  
 31003  
 31003  
 31003  
 31003  
 31003

## REMA lifting clamps info

### REMA® is a leader in the production and sale of lifting clamps.

- Each lifting clamp is supplied with a valid factory test certificate.
- All lifting clamps have a type approval according to labor inspection.

### Features of REMA® lifting clamps

- Excellent quality and finish.
- Very compact design and light weight.
- Great hardness of the segments (HrC 54).
- High wear resistance and long service life.
- A safety factor of 5 or higher against breakage.
- An extensive range of tonnages with different jaw openings.
- The lifting clamps are easy to repair, parts can be delivered as a package.
- The vertical clamps are provided with a safety lever that exerts an initial force on the plate by means of a spring, so that it cannot fall out of the clamp.
- Each clamp is subjected to a test load (2 x WLL).

### REMA® lifting clamps meet the highest quality requirements at European level and the NEN-EN-13155 standard.

## Important information before use

- Do not exceed rated operational loads!
- Avoid abrupt loading!
- Utilize the full depth of jaw openings when gripping sheets or beams.
- Make sure that safety lever is closed before starting lifting.
- With long sheets or beam, use a multiple of clamps.
- Do not use any damaged lifting clamps.
- Maximum hardness of sheets or beams to be lifted is HRC 37 (345 HB).
- Do not lift more than one sheet at a time.
- Lifting clamps are not intended to be in permanent connection with gripped-in sheets or beams (except for models CSV).
- Do not carry out welding operations on clamps as they can affect original hardness of clamps.
- Do not use lifting clamps exceeding temperature range -40° to +100°C.
- When lifting and lowering loads, do not stand in close proximity of the load.
- Prevent situations when persons may stay below suspended loads.
- It is very important to develop procedures in compliance with periodic inspections must be completed.
- Read the attached operating instructions before use.

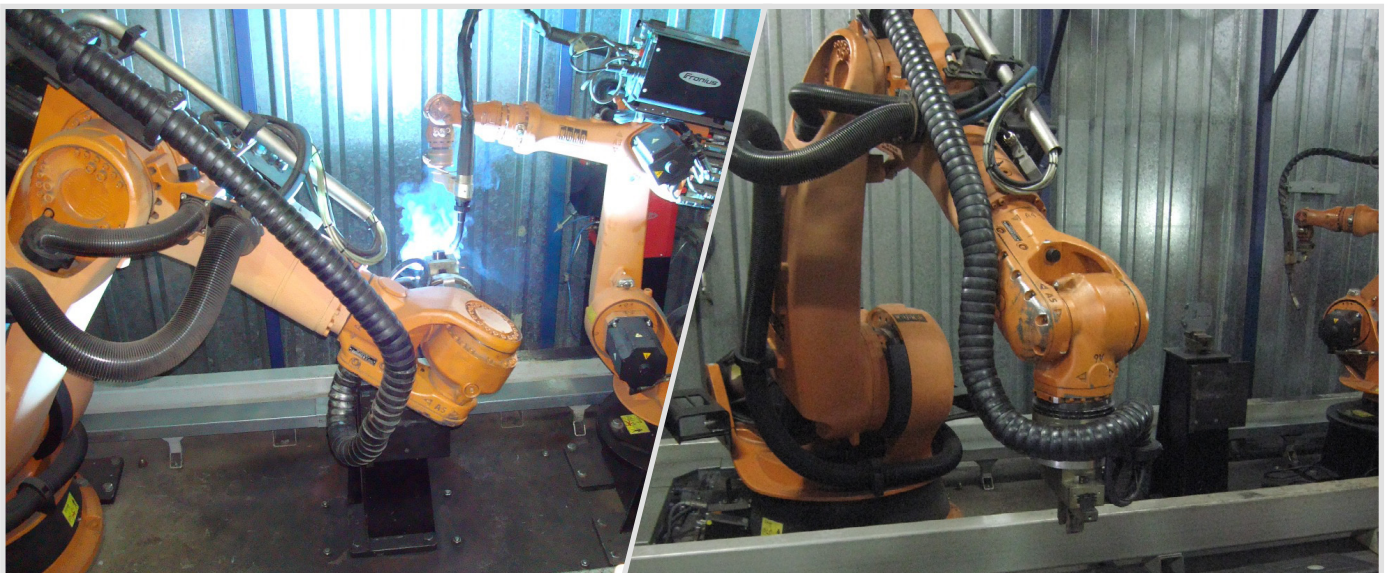

**CNM non-marking vertical plate lifting clamps**



The CNM clamp is equipped with 2 clamping jaws that are provided with special synthetic plastic. After hoisting, the clamp leaves no damage. The clamp is locked in the closed and open position.

**Properties**

- Equipped with synthetic plastic jaws.

**Application**

- For hoisting and transporting of, stainless steel, aluminum, wood and natural stone where the work-piece can not be damaged.

**Norm:**

- EN12100-1/2, EN13155, AS4991, ASME-B30,20

**Safe workload when used under different angles**

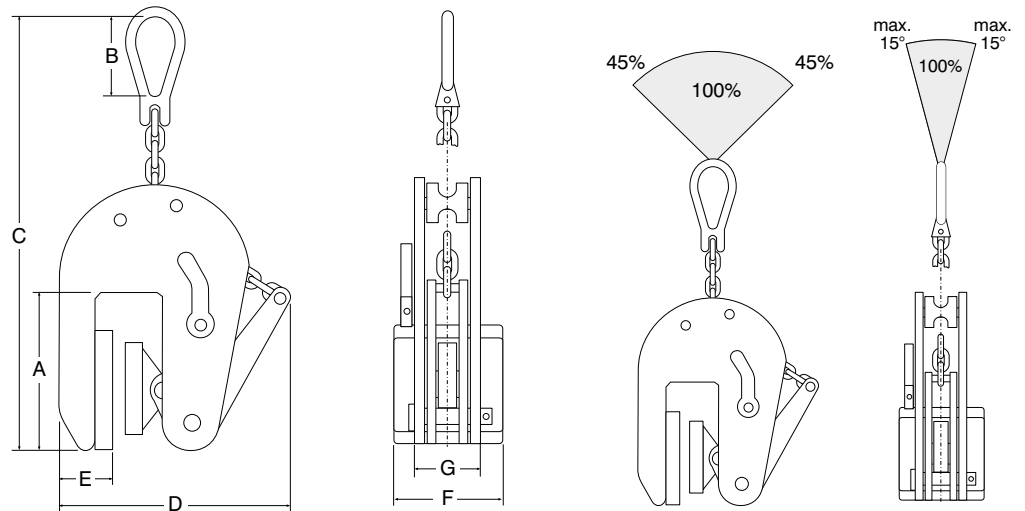

Type	WLL (kg)	Jaw opening (mm)	A (mm)	B (mm)	C (mm)	D (mm)	E (mm)	F (mm)	G (mm)	Weight (kg)	ProductId
CNM-0.5	500	1-20	102	65	462	224	48	80	48	6.0	3315001
CNM-0.5G	500	17-37	102	65	462	241	48	80	48	6.0	3315003
CNM-1.0	1000	1-30	105	80	470	282	46	80	54	6.5	3315000
CNM-1.5	1500	1-40	105	80	470	282	46	80	54	6.5	3315002
CNM-2.0	2000	1-50	124	100	704	408	63	80	65	15.0	3315004
CNM-3.0	3000	1-60	124	100	704	408	63	80	65	15.5	3315005

**CNMA vertical non-marking lifting clamp**



The CNMA clamp is equipped with 2 clamping jaws that are provided with special synthetic plastic. After hoisting, the clamp leaves no damage. The clamp is locked in the closed and open position.

**Properties**

- Only available in 500 KG version.
- Equipped with synthetic plastic jaws.
- Jaw opening adjustable in steps of 20 mm from 3 to 180 mm.

**Application**

- For hoisting and transporting of stainless steel, aluminum, wood and natural stone where the work-piece can not be damaged.

**Norm:**

- EN12100-1/2, EN13155, AS4991, ASME-B30,20

**Safe workload when used under different angles**

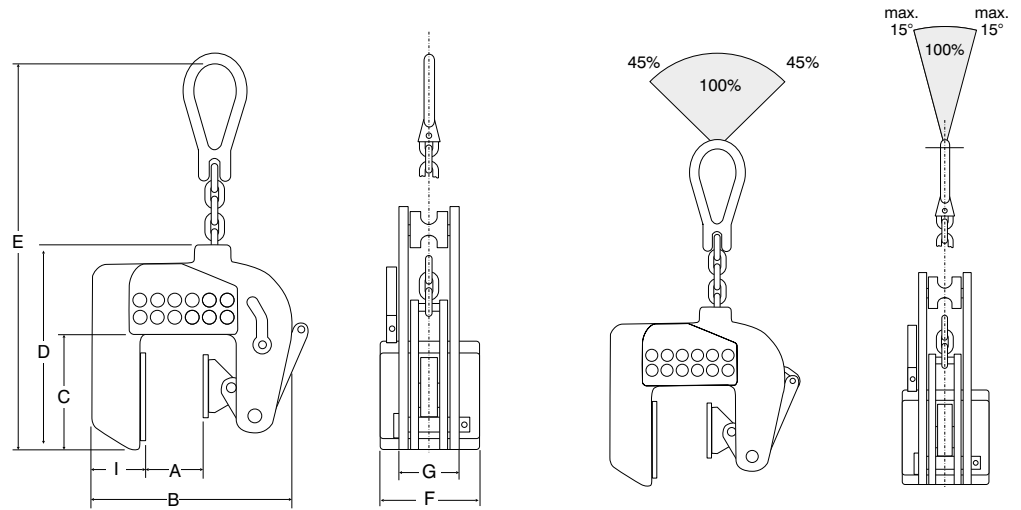

Type	WLL (kg)	Jaw opening (mm)	A (mm)	B (mm)	C (mm)	D (mm)	E (mm)	F (mm)	G (mm)	I (mm)	Weight (kg)	ProductId
CNMA-05	500	1-180	0-180	220-340	143	223	360	80	66	61	10	3315006

**CS vertical plate lifting clamps**



Lifting clamps for safely transporting steel plates in vertical position.  
**Minimum weight to be lifted is 10% of the safe workload.**

**Properties**

- Equipped with standard lifting eye, movable in one direction.
- Always equipped with a safety mechanism, ensuring the clamp does not slip when lifting force is applied and when load is being lowered.
- WLL and size of the jaw opening are clearly indicated on the clamp.
- Safety factor of at least 5 x WLL.
- Each clamp is 2x WLL testloaded.

**Application**

- For lifting steel plates up to a hardness of 37 RC (345 HB).
- Suitable for lifting, 180 ° turning and vertical transport of steel plates.

**Norm:**

- EN12100-1/2, EN13155, AS4991, ASME-B30,20

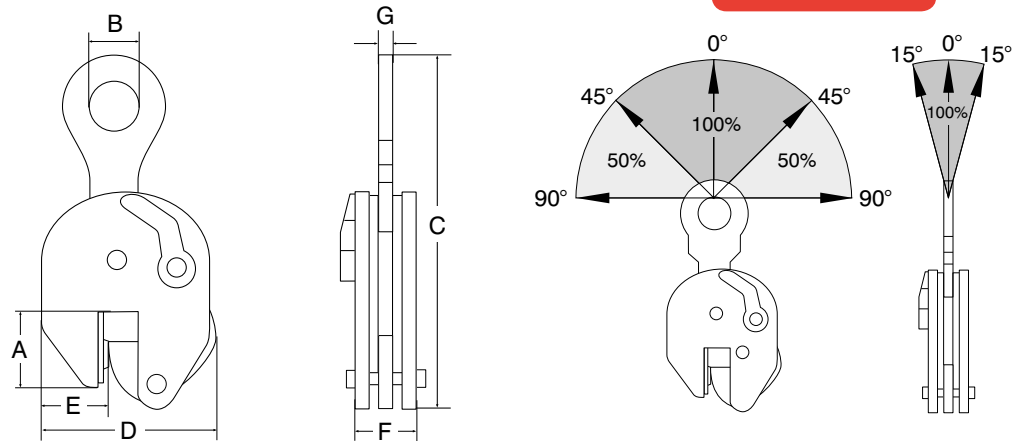

**Safe workload when used under different angles**

Type	WLL (kg)	Jaw opening (mm)	A (mm)	B (mm)	C (mm)	D (mm)	E (mm)	F (mm)	G (mm)	Weight (kg)	ProductId
CS-0.75	750	0-13	47	30	205	100	35	37	10	1.5	3360001
CSE-1.0	1000	0-25	55	45	265	142	38	47	15	3.6	3360002
CS-2.0	2000	0-35	80	65	335	185	55	56	17	6.5	3361002
CS-3.0	3000	0-35	80	65	335	185	55	56	17	7	3361003
CS-4.0	4000	0-45	85	70	430	230	60	78	20	16	3361004
CS-6.0	6000	0-50	114	75	490	255	78	78	20	20	3361006
CS-9.0	9000	0-55	112	75	530	267	70	86	20	26	3361009
CS-12.0	12000	0-52	148	85	617	295	100	94	44	42	3361013
CS-15.0	15000	0-75	159	86	760	375	135	105	50	71	3361015

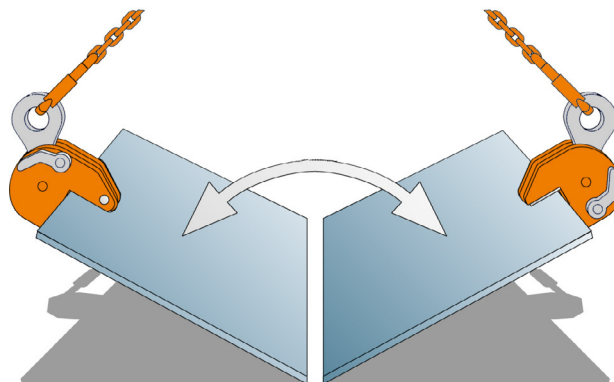

**CS-H vertical plate lifting clamps for steel plates up to a hardness of 50RC (485HB)**



Lifting clamps for safely transporting steel plates in vertical position.  
**Minimum weight to be lifted is 10% of the safe workload.**

**Properties**

- Equipped with standard lifting eye, movable in one direction.
- Always equipped with a safety mechanism, ensuring the clamp does not slip when lifting force is applied and when load is being lowered.
- WLL and size of the jaw opening are clearly indicated on the clamp.
- Safety factor of at least 5 x WLL.
- Each clamp is 2x WLL testloaded.

**Application**

- For lifting steel plates up to a hardness of 50 RC (485 HB).
- Suitable for lifting, 180 ° turning and vertical transport of steel plates.

**Norm:**

- EN12100-1/2, EN13155, AS4991, ASME-B30,20

**Safe workload when used under different angles**

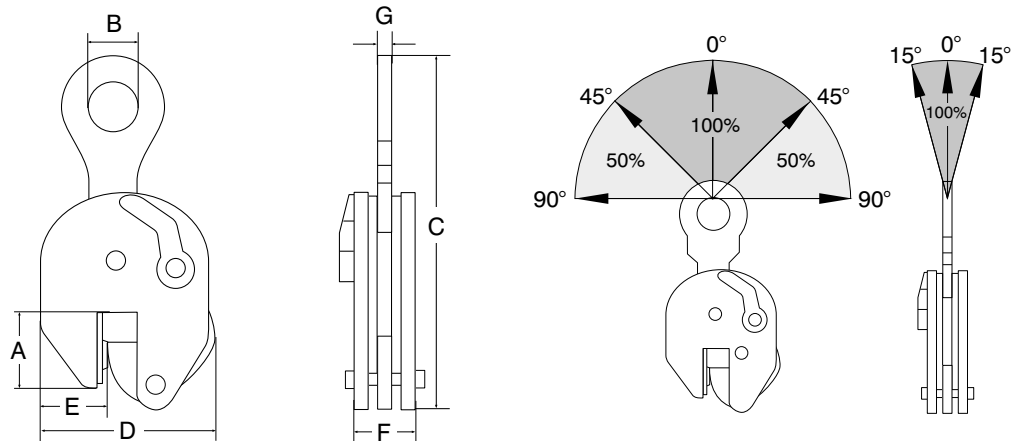

Type	WLL (kg)	Jaw opening (mm)	A (mm)	B (mm)	C (mm)	D (mm)	E (mm)	F (mm)	G (mm)	Weight (kg)	ProductId
CS-0.75H	750	0-13	47	30	205	100	35	37	10	1.5	3361101
CS-1.0H	1000	0-25	55	45	265	142	38	47	15	3.6	3361103
CS-2.0H	2000	0-35	80	65	335	185	55	56	17	6.5	3361105
CS-3.0H	3000	0-35	80	65	335	185	55	56	17	7	3361107
CS-4.5H	4500	0-45	85	70	430	230	60	77	20	16	3361109
CSE-6.0H	6000	0-50	114	78	527	259	82	78	32	24	3361112

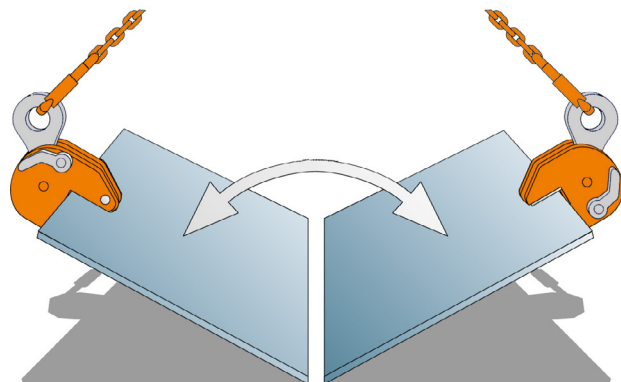

**CU universal plate lifting clamps**



Lifting clamps for safely transporting steel plates in vertical position.  
**Minimum weight to be lifted is 10% of the safe workload.**

**Properties**

- Equipped with universal lifting eye, movable in two directions.
- Always equipped with a safety mechanism, ensuring the clamp does not slip when lifting force is applied and when load is being lowered.
- WLL and size of the jaw opening are clearly indicated on the clamp.
- Safety factor of at least 5 x WLL.
- Each clamp is 2x WLL testloaded.

**Application**

- For lifting steel plates up to a hardness of 37 RC (345 HB).
- Suitable for lifting, 180 ° turning and vertical transport of steel plates.

**Norm:**

- EN12100-1/2, EN13155, AS4991, ASME-B30,20

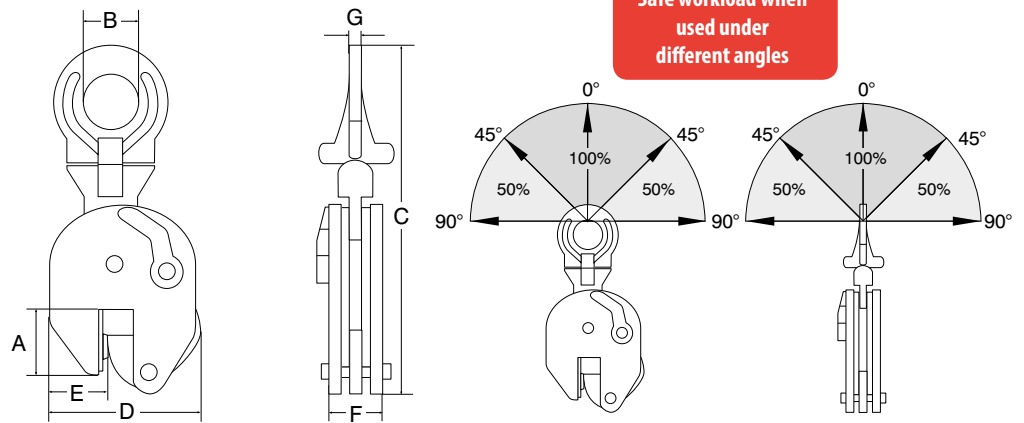

Type	WLL (kg)	Jaw opening (mm)	A (mm)	B (mm)	C (mm)	D (mm)	E (mm)	F (mm)	G (mm)	Weight (kg)	ProductId
CU-0.75	750	0-13	47	30	203	100	35	37	10	1.7	3362001
CUE-1.0	1000	0-25	55	50	295	125	38	47	14	3.9	3362002
CU-2.0	2000	0-35	80	70	370	185	55	56	16	7.3	3363002
CU-3.0	3000	0-35	80	70	370	185	55	56	16	8	3363003
CU-4.0	4000	0-45	85	70	430	230	60	78	20	17	3363004
CU-6.0	6000	0-50	114	78	527	255	78	78	32	22	3363006
CU-9.0	9000	0-55	112	78	565	267	70	86	45	30	3363009
CU-12.0	12000	0-52	148	85	650	295	100	94	48	44	3363013
CU-15.0	15000	0-76	159	85	765	373	136	106	48	75	3363015

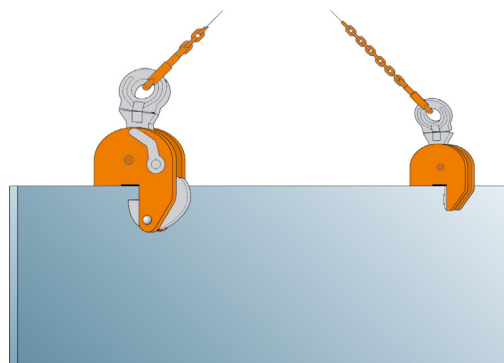

**CU-H universal plate lifting clamps for steel plates up to a hardness of 50RC (485HB)**



Lifting clamps for safely transporting steel plates in vertical position.  
**Minimum weight to be lifted is 10% of the safe workload.**

**Properties**

- Equipped with universal lifting eye, movable in two directions.
- Always equipped with a safety mechanism, ensuring the clamp does not slip when lifting force is applied and when load is being lowered.
- WLL and size of the jaw opening are clearly indicated on the clamp.
- Safety factor of at least 5 x WLL.
- Each clamp is 2x WLL testloaded.

**Application**

- For lifting steel plates up to a hardness of 50 RC (485 HB).
- Suitable for lifting, 180 ° turning and vertical transport of steel plates.

**Norm:**

- EN12100-1/2, EN13155, AS4991, ASME-B30,20

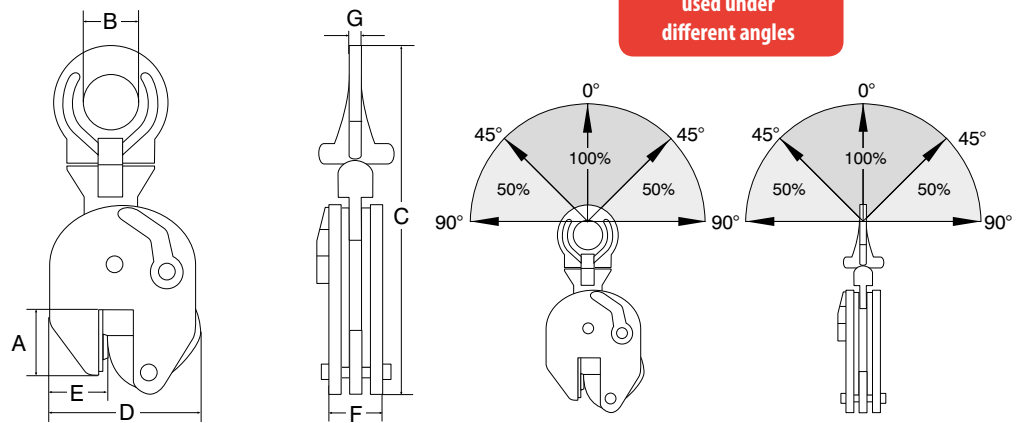

Type	WLL (kg)	Jaw opening (mm)	A (mm)	B (mm)	C (mm)	D (mm)	E (mm)	F (mm)	G (mm)	Weight (kg)	ProductId
CU-0.75H	750	0-13	47	30	203	100	35	37	10	1.7	3363101
CU-1.0H	1000	0-25	55	50	295	142	38	47	14	3.9	3363103
CU-2.0H	2000	0-35	80	70	370	185	55	56	16	7.3	3363105
CU-3.0H	3000	0-35	80	70	370	185	55	56	16	8	3363107
CU-4.5H	4500	0-45	85	70	430	230	60	78	20	17	3363109
CUE-6.0H	6000	0-50	114	78	527	259	82	78	32	24	3363112

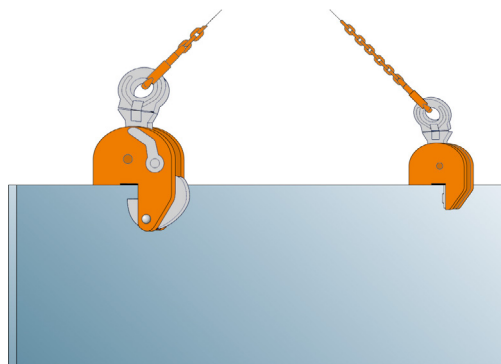



**CUER plate lifting clamps for hoisting stainless steel plates**



For safe lifting and transporting in vertical position of stainless steel plates.

**Minimum weight to be lifted is 10% of the safe workload.**

**Properties**

- Segment, segment axis and pivots are made of stainless steel.
- The housing and the latch pin are nickel plated to prevent the contact between carbon steel and stainless steel plates.
- Always equipped with a safety mechanism, ensuring the clamp does not slip when lifting force is applied and when load is being lowered.

**Norm:**

- EN12100-1/2, EN13155, AS4991, ASME-B30,20

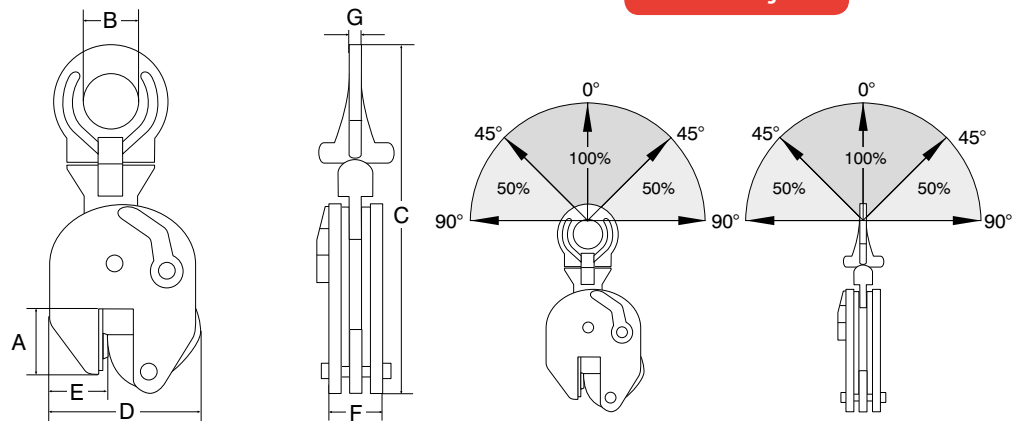

Safe workload when used under different angles

Type	WLL (kg)	Jaw opening (mm)	A (mm)	B (mm)	C (mm)	D (mm)	E (mm)	F (mm)	G (mm)	Weight (kg)	ProductId
CUER-1.0	1000	0-25	56	50	292	141	37	47	15	3.8	3363301
CUER-2.0	2000	0-35	78	70	372	183	56	56	16	8	3363302

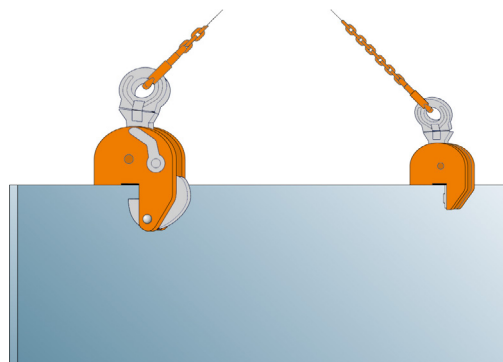

**CSEU vertical lifting clamp**



For hoisting and transporting plates and constructions from any position.  
**Minimum weight to be lifted is 10% of the safe workload.**

**Properties**

- When 1 Clamp with a varying jaw opening is required.
- Adaptable in steps of 30 mm.
- Strong and lightweight construction.

**Norm:**

- EN12100-1/2, EN13155, AS4991, ASME-B30,20

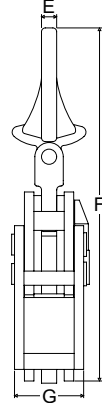
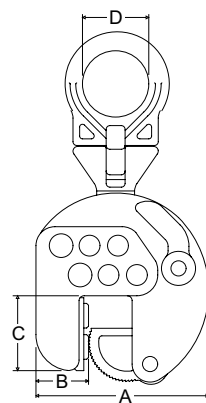

**Safe workload when used under different angles**

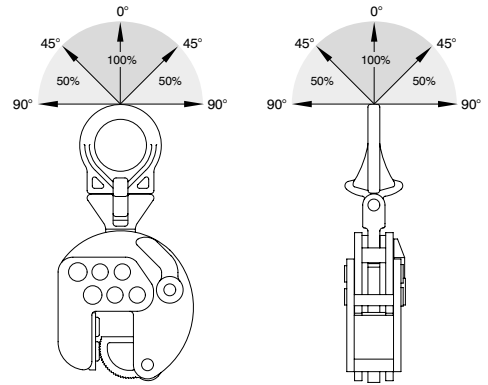

Type	WLL (kg)	Jaw opening (mm)	A (mm)	B (mm)	C (mm)	D (mm)	E (mm)	F (mm)	G (mm)	Weight (kg)	ProductId
CSEU-3	3000	0-95	182-245	55	80	70	16	370	73	11	3313020

**CBT vertical lifting clamp with movable pivot.**



For vertical lifting and transporting (thin) sheet metal. Special movable pivot in the clamp provide extra pressure on the material, eliminating the risk of slippage.  
 No minimum weight required.

**Norm:**

- EN12100-1/2, EN13155, AS4991, ASME-B30,20

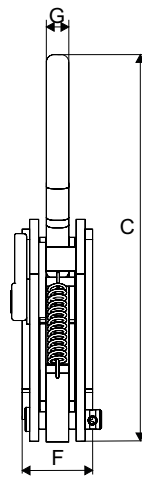
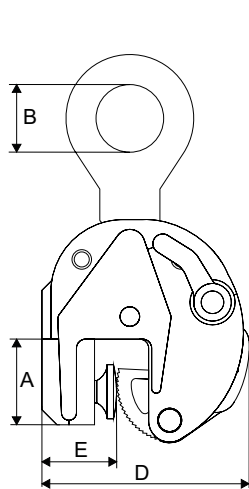

**Safe workload when used under different angles**

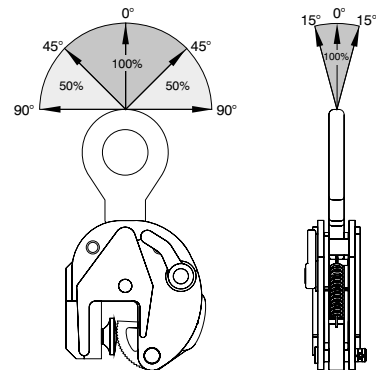

Type	WLL (kg)	Jaw opening (mm)	A (mm)	B (mm)	C (mm)	D (mm)	E (mm)	F (mm)	G (mm)	Weight (kg)	ProductId
CBT-0.25	250	0-13	53	30	200	110	50	38	10.5	1.85	3364000
CBT-1	1000	0-20	57	45	258	138	50	47	15	4	3364001

**CBTU universal plate clamp with movable pivot.**



For vertical lifting and transporting (thin) sheet metal. Special movable pivot in the clamp provide extra pressure on the material, eliminating the risk of slippage. No minimum weight required.

**Properties**

- Movable pivots.
- Universal lifting eye.

**Norm:**

- EN12100-1/2, EN13155, AS4991, ASME-B30,20

Safe workload when used under different angles

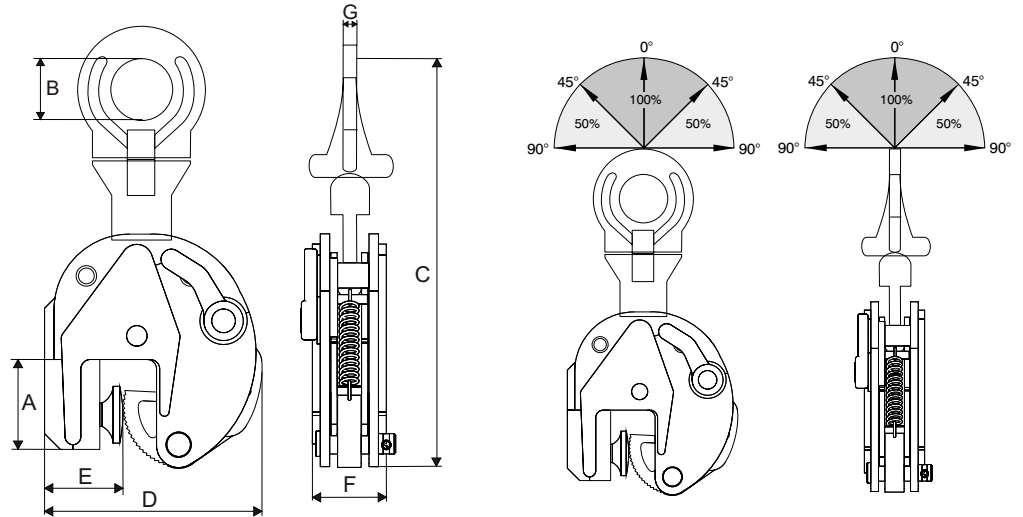

Type	WLL (kg)	Jaw opening (mm)	A (mm)	B (mm)	C (mm)	D (mm)	E (mm)	F (mm)	G (mm)	Weight (kg)	ProductId
CBTU-0.25	250	0-13	53	30	200	110	50	38	10.5	2	3364100

## CH horizontal plate lifting clamps



Lifting clamps for safe transportation of steel plates in horizontal position. For hoisting steel plates up to hardness 37 RC (345 HB).

### Properties

- WLL and size of the jaw opening are clearly indicated on the clamp.
- Suitable for hoisting and horizontal transport of steel plates that do not bend.
- These clamps can also be applied under a lifting frame or chain sling.
- Always use in pair.
- Low weight and compact design.
- Safety factor of at least 5 x WLL.
- Each clamp is 2 x WLL testloaded.

### Application

- For lifting steel plates up to hardness 37 RC (345 HB).
- For the safe transport of steel plates in horizontal position.

### Norm:

- EN12100-1/2, EN13155, AS4991, ASME-B30,20

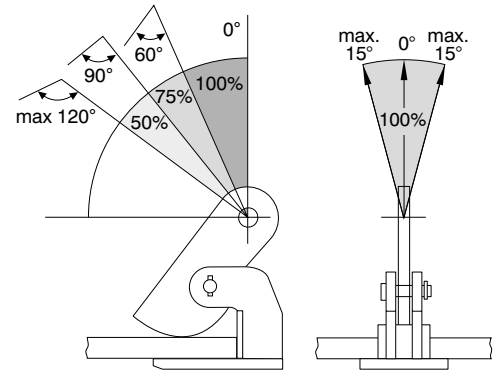
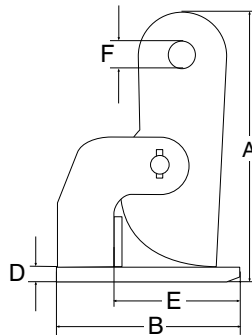
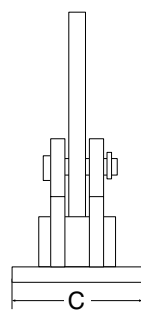

Safe workload when used under different angles

Type	WLL/pair (kg)	Jaw opening (mm)	A (mm)	B (mm)	C (mm)	D (mm)	E (mm)	F (mm)	Weight/pair (kg)	ProductId
CH-1.0	1000/2	0- 35	188	140	65	10	100	25	5.2/2	3365001
CH-2.0	2000/2	0- 60	290	180	90	15	115	31	15/2	3365002
CH-4.0	4000/2	0- 60	306	220	105	25	145	31	26/2	3365004
CH-6.0	6000/2	0- 60	306	220	110	25	145	31	26/2	3365006
CH-8.0	8000/2	0- 60	335	225	120	35	135	31	36/2	3365008
CH-10.0	10000/2	0- 60	335	225	120	35	135	31	40/2	3365010
CH-2.0/L	2000/2	0-100	380	180	90	15	120	31	18/2	3365102
CH-4.0/L	4000/2	0-100	415	220	105	25	145	31	30/2	3365104
CH-6.0/L	6000/2	0-100	415	220	120	25	145	31	32/2	3365106
CH-8.0/L	8000/2	0-100	430	225	120	35	135	31	44/2	3365108
CH-10.0/L	10000/2	0-100	430	225	120	35	135	31	46/2	3365110

## CHT horizontal lifting clamps for thin plates



CHT lifting clamps with reverse segments for safe transportation of thin steel plates sagging during lifting.

### Properties

- Always use per pair.
- WLL and the size of the jaw opening are clearly marked on the clamp.
- Safety factor of at least 5 x WLL.
- Each clamp is 2 x WLL test load.

### Application

- For lifting thin sheet steel plates in horizontal position to a hardness of 37RC (345 HB).

### Norm:

- EN12100-1/2, EN13155, AS4991, ASME-B30,20

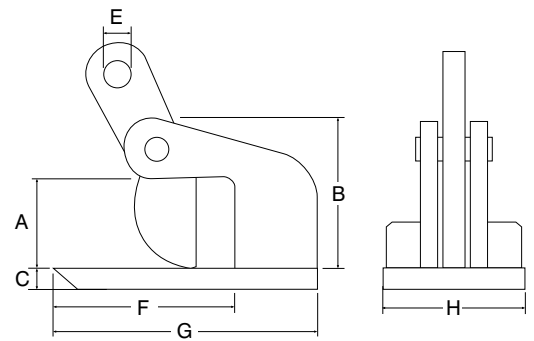
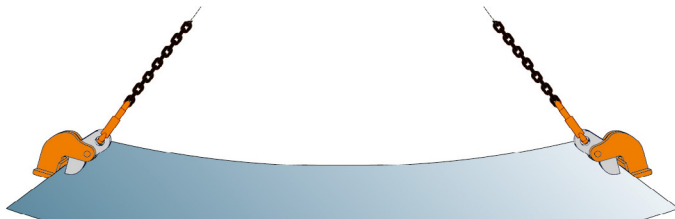

Type	WLL/pair (kg)	Jaw opening (mm)	A (mm)	B (mm)	C (mm)	E (mm)	F (mm)	G (mm)	H (mm)	Weight/pair (kg)	ProductId
CHT-1.0	1000/2	0-15	0-15	85	10	22.5	99	140	65	5/2	3309001
CHT-2.0	2000/2	0-35	0-35	135	20	26	114	180	90	16/2	3309002

## CNMH horizontal lifting clamp



REMA horizontal clamps are for the safe transport of flat sheets where the surface may not be damaged e.g. stainless steel, aluminum, wood etc. The clamp and bed of the clamp are covered with a high-quality pressure-resistant plastic.

### Application

- For the horizontal transport of stainless steel plates, various wooden panels, aluminum etc.

### Norm:

- EN12100-1/2, EN13155, AS4991, ASME-B30,20

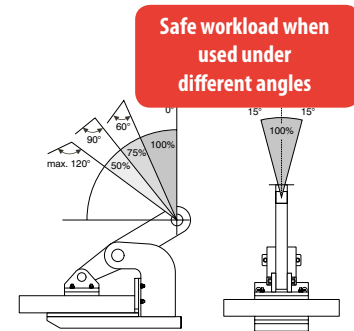
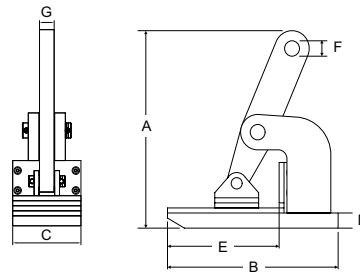

Type	WLL/pair (kg)	Jaw opening (mm)	A (mm)	B (mm)	C (mm)	D (mm)	E (mm)	F (mm)	G (mm)	Weight/pair (kg)	ProductId
CNMH-1	1000/2	0-25	154	140	65	15	95	20.0	15	7	3366001
CNMH-2	2000/2	0-45	270	225	90	23	150	30.5	15	18	3366002
CNMH-3	3000/2	0-45	275	225	90	28	150	30.5	15	26	3366003
CNMH-4	4000/2	0-50	305	250	105	28	160	30.5	20	32	3366004
CNMH-6	6000/2	0-50	310	250	120	33	160	30.5	20	34	3366006

**CHTV horizontal lifting clamps with spring**



REMA CHTV horizontal clamps are fitted with a torsion spring so that the lifting clamp remains closed at the desired location. 1 person can place 4 clamps and operate the crane.

**Application**

- 1 person can place 4 clamps and operate the crane.

**Norm:**

- EN12100-1/2, EN13155, AS4991, ASME-B30,20

**Safe workload when used under different angles**

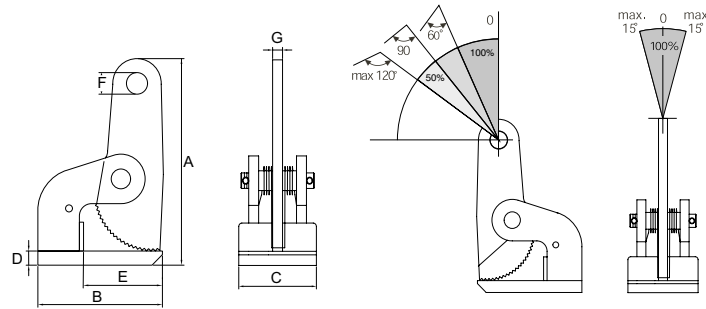

Type	WLL /pair (kg)	Jaw opening (mm)	A (mm)	B (mm)	C (mm)	D (mm)	E (mm)	F (mm)	G (mm)	Weight / pair (kg)	ProductId
CHTV-1	1000/2	0-35	193	140	85	10	100	25	15	6/2	3369001
CHTV-2	2000/2	0-60	290	180	125	15	115	30.5	16	18/2	3369002
CHTV-3	3000/2	0-60	293	180	125	20	115	30.5	16	20/2	3369003
CHTV-4	4000/2	0-60	310	220	165	30	140	30.5	20	30/2	3369004
CHTV-6	6000/2	0-60	310	220	165	30	140	30.5	20	30/2	3369006

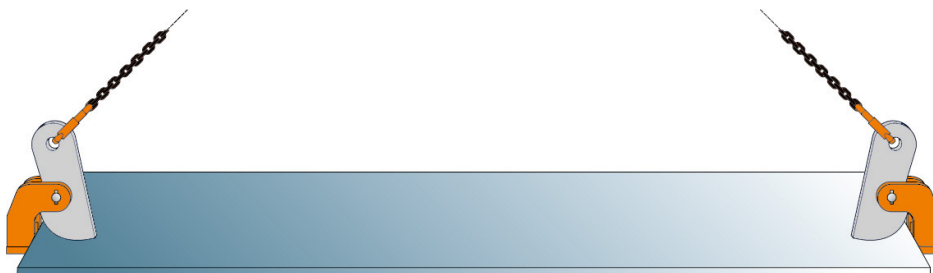

## CHV horizontal adjustable lifting clamps



Adjustable lifting clamp for safe lifting and moving of packages and single plates in horizontal position. Always use these clamps per pair.

### Norm:

- EN12100-1/2, EN13155, AS4991, ASME-B30,20

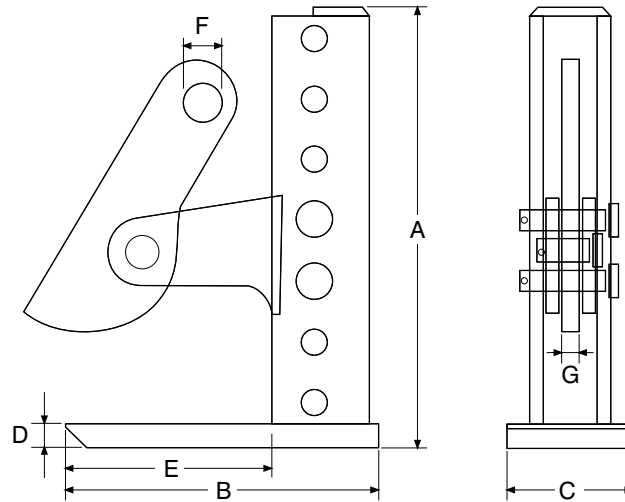

Type	WLL/pair (kg)	Jaw opening (mm)	A (mm)	B (mm)	C (mm)	D (mm)	E (mm)	F (mm)	G (mm)	Weight/pair (kg)	ProductId
CHV-1.5	1500/2	3-180	290	200	90	15	135	30	20	18/2	3315011
CHV-1.5X	1500/2	3-300	410	200	90	15	135	30	20	23/2	3315013
CHV-3.0	3000/2	3-180	300	235	105	20	165	30	20	29/2	3315015
CHV-3.0X	3000/2	3-300	410	235	105	20	165	30	20	31/2	3315017
CHV-4.5	4500/2	3-180	300	235	105	20	165	30	20	32/2	3315019
CHV-4.5X	4500/2	3-420	535	235	105	20	170	30	20	34/2	3315021
CHV-6.0	6000/2	3-180	305	250	120	25	160	30	20	40/2	3315023
CHV-6.0X	6000/2	3-420	540	250	120	25	165	30	20	46/2	3315025
CHV-9.0	9000/2	3-180	305	250	120	25	160	30	20	51/2	3315027
CHV-9.0X	9000/2	3-420	540	250	120	25	165	30	20	60/2	3315029

**CSH screw clamps**



CSH screw clamps. For positioning and turning steel plates, steel sections and curved plates. As the load increases, the force is distributed over a larger part of the segment.

**Application**

- The CSH screw clamp is suitable for lifting and transporting steel objects in horizontal and vertical positions.

**Norm:**

- EN12100-1/2, EN13155

**Safe workload when used under different angles**

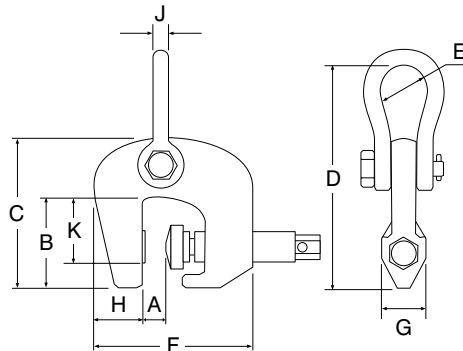
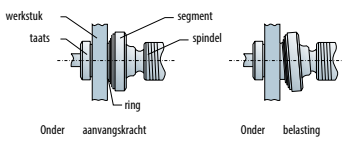
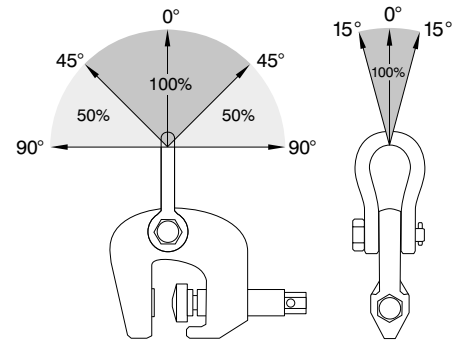

Type	WLL (kg)	Jaw opening (mm)	A (mm)	B (mm)	C (mm)	D (mm)	E (mm)	F (mm)	G (mm)	H (mm)	J (mm)	K (mm)	Weight (kg)	Productid
CSH-0.5	500	0-35	0-35	45.5	82	211	25	108	27	26	10	158	1.0	3313003
CSH-1.0	1000	0-40	0-40	82	128	204	38	175	46	46	12	210	3.2	3313006
CSH-1.5	1500	0-40	0-40	71	140	232	46	150	46	40	16	220	3.5	3313007
CSH-3.0	3000	0-60	0-60	88	184	278	50	190	60	46	19	280	7.8	3313009
CSH-6.0	6000	0-100	0-100	123	249	390	100	296	75	70	32	446	22	3313011

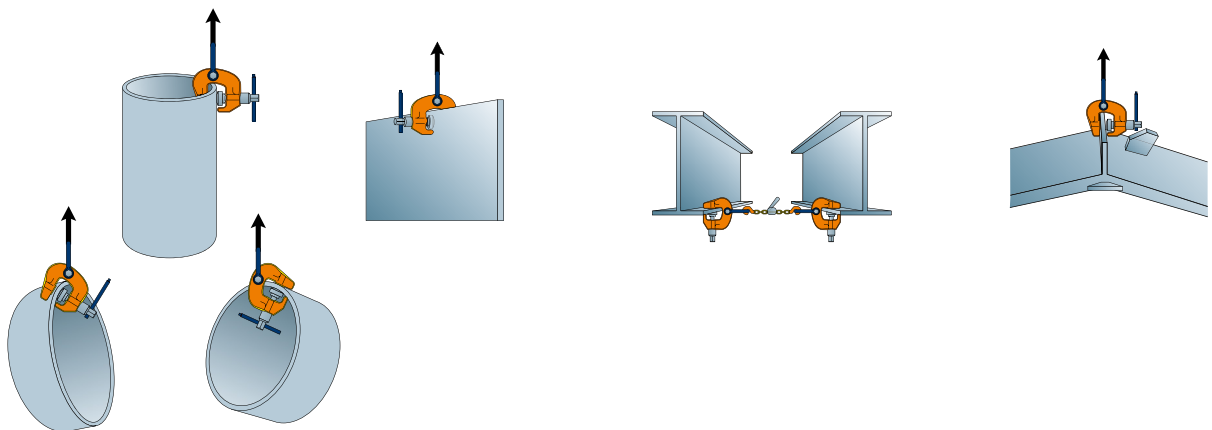



**WF-screw clamp**



WF screw clamps are the lightest clamps with the highest capacity by means of a double round pivot. Special high-quality Alloy steel housing provides a safety factor of 8. The clamp is equipped with a double locking mechanism with movable pivots that guarantees increased clamping capacity.

**Properties**

- Double round pivot locking, resulting in stronger clamping force and safe operation.
- Because of the two attachment holes it is possible to carry out work in all directions.
- This clamp can be used to hoist inclined loads such as I-beams.
- Fine adjusting screw thread.
- Preservation powder coating.
- The pivots and the screw are specially treated to prevent rusting.

**Application**

- Hoisting and transport work: Steel material, including H-beams, I-beams, steel plates, tubes, angle profiles and steel posts, as well as steel beams, pillars, welded objects and other workpieces.
- Lowering workpieces easily with any hoisting equipment.
- Dragging steel plates to arrange them on the ground.

**Norm:**

- EN12100-1/2, EN13155

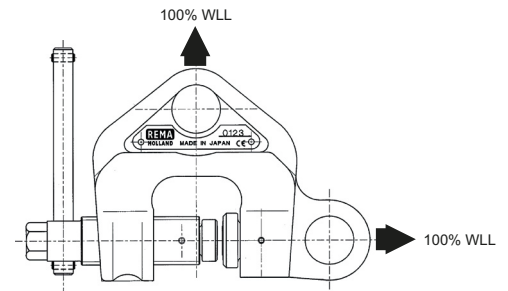
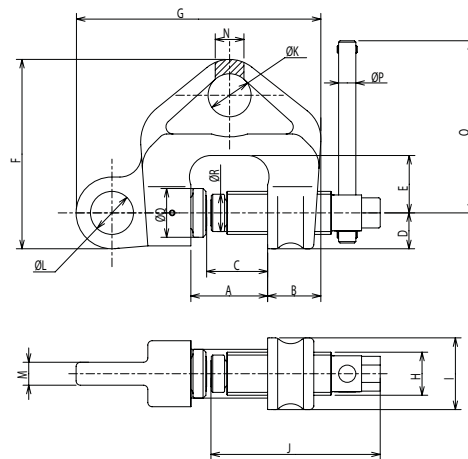
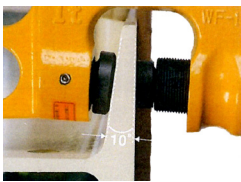
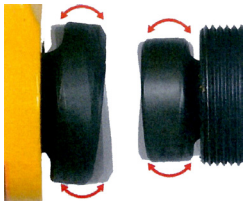

Type	WLL (kg)	Minimum load (kg)	Jaw opening (mm)	Weight (kg)	ProductId
WF-0.5	500	50	3-28	1.5	3316001
WF-1.0	1000	100	3-40	2.9	3316003
WF-2.0	2000	200	3-45	4.9	3316005
WF-3.0	3000	300	6-49	7.2	3316007
WF-5.0	5000	500	9-53	10.0	3316009

Type	A (mm)	B (mm)	C (mm)	D (mm)	E (mm)	F (mm)	G (mm)	H (mm)	I (mm)	J (mm)	K (mm)	L (mm)	M (mm)	N (mm)	O (mm)	P (mm)	Q (mm)	R (mm)
WF-0.5	41	32	30.5	21	33	108	138	34	42	10	25	24.5	12	16	120	10	26	21
WF-1.0	53.5	38	42.5	25	40	132	172	34	50	10	30	29.5	16	20	120	12	34	26
WF-2.0	60	45	47.5	31	41	157	202	34	62	10	34	33.0	22	28	150	12	36	29
WF-3.0	65.5	52	51.5	35	44	170	230	34	70	10	35	40.5	28	33	160	12	40	36
WF-5.0	71	57	55.5	38	46	187	248	34	75	10	40	45.0	38	40	180	12	41	36

**CBV beam clamps**



Designed for safe lifting and transportation of steel beams in vertical position.

**Application**

- For vertical lifting, transportation and stacking of steel (H) beams, profiles and structures where the load must stay perfectly in position
- Especially recommended for transportation and stacking of steel (H) beams (e.g. when sawing of steel beams, stacking of steel beams and building of steel constructions)
- Jaw openings available from: 0 to 25 mm.
- note: the plate surface of the material must have a hardness level of max. Hrc 37/345 Hb
- **Minimum weight to be lifted is 10% of the safe workload.**

**Norm:**

- EN12100-1/2, EN13155, AS4991, ASME-B30,20

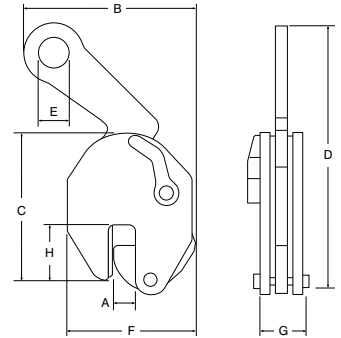
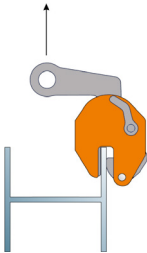

Type	WLL (kg)	Jaw opening (mm)	A (mm)	B (mm)	C (mm)	D (mm)	E (mm)	F (mm)	G (mm)	H (mm)	Weight (kg)	ProductId
CBV-1.0	1000	0-15	0-15	175	150	226	35	130	35	47	4	3313000
CBV-2.0	2000	0-20	0-20	265	200	345	60	165	56	67	8	3313001
CBV-3.0	3000	0-25	0-25	325	235	410	72	192	77	65	16	3313002

**COBK beam lifting clamp**



COBK beam lifting clamp is made with a safety mechanism that makes sure that the beam cannot slide out of the clamp during transport. The clamp is locked in open and closed position.

**Application**

- For horizontal lifting, transportation and stacking of steel (H) beams, profiles and structures.
- Jaw openings available from: 3 to 20 mm.

**Norm:**

- EN12100-1/2, EN13155, AS4991, ASME-B30,20

**Option**

- Other capacities and jaw openings.

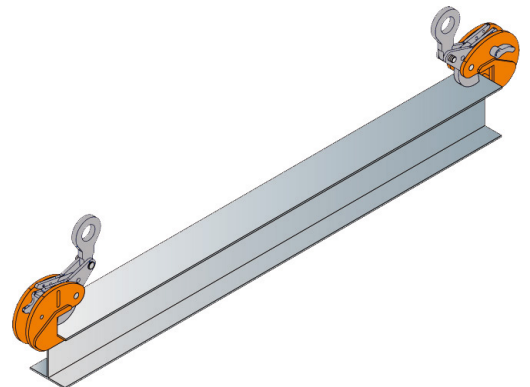
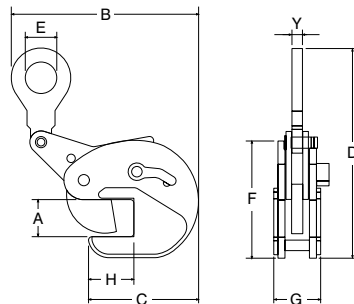

Type	WLL/pair (kg)	Jaw opening (mm)	A (mm)	B (mm)	C (mm)	D (mm)	E (mm)	F (mm)	G (mm)	H (mm)	Y (mm)	Weight/pair (kg)	ProductId
COBK-2.0	2000	3-20	3-20	285	157	295	64	155	67	65	17	19	3313022

**CBS - bulb screw clamps for HP-profiles**



**Properties**

- Equipped with a thread spindle for easy attachment, providing a powerful clamping force on the workpiece
- Lightweight design for easy handling
- Tough quality heavy duty body
- Maintenance-friendly, easy to exchange parts which are available upon request

**Application**

- For use as a (temporary) lifting point in spaces with HP- (bulb) profiles, like sectional ship parts and ship engine rooms.
- The moment a load is applied, the clamp is automatically applied.
- Used for HP-100 to HP-240 (bulb) profiles.
- Working load limit (WLL) 1500 - 3000kg.

**Norm:**

- EN12100-1/2, EN13155

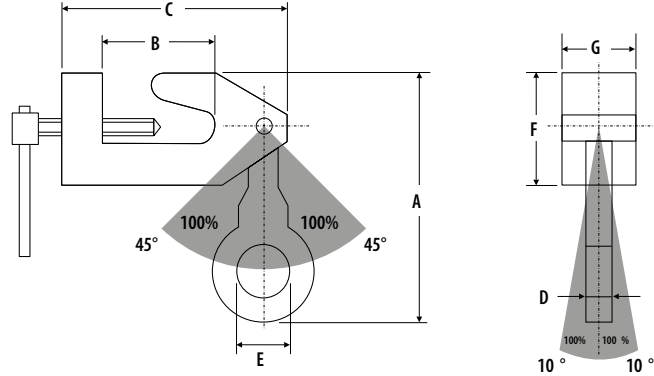

Type	WLL (kg)	Jaw opening (mm)	A (mm)	B (mm)	C (mm)	D (mm)	E (mm)	F (mm)	G (mm)	Weight (kg)	ProductId
CBS-1.5	1500	HP100-240	180	75	150	16	45	75	40	3	3313018
CBS-3.0	3000	HP100-240	205	75	150	16	45	75	80	6.5	3313019

**CBU Lightweight Holland profile (Hp) clamp for universal lifting**



Specifically developed for lifting and transportation HP profiles and ship constructions using HP profiles. Fitted with 2 cams and universal lifting eyes.

**Application**

- For vertical lifting, handling and transporting of Holland Profile (HP) shipbuilding structures from all positions
- Jaw openings available from: 0 to 45 mm
- Higher WLL available upon request . Min . WLL is 10% of max . WLL
- Lifting of longer sections should be performed with a spreader beam fitted with multiple clamps.

**Norm:**

- EN12100-1/2, EN13155, AS4991, ASME-B30,20

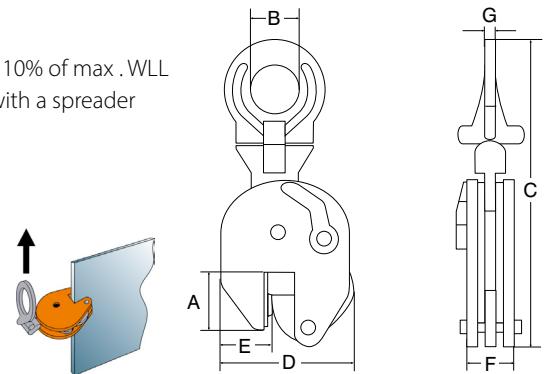

Type	WLL (kg)	Jaw opening (mm)	A (mm)	B (mm)	C (mm)	D (mm)	E (mm)	F (mm)	Weight (kg)	ProductId
CBU-3.0	3000	0-35	90	70	370	185	55	54	8	3310001
CBU-5.0	5000	0-45	110	70	435	225	60	86	17.3	3310003

**CBL bulb lifting clamp with extra large jaw opening**



**Properties**

- Standard with 3 pivots for extra powerful clamping force.
- Clamp is locked in closed as well as open position.
- Always equipped with a safety mechanism, ensuring the clamp does not slip when lifting force is applied and when load is being lowered.

**Application**

- For vertical lifting, handling and transporting of Holland Profile (HP) shipbuilding structures, steel plates and structures.
- Lifting of longer sections should be performed with a spreader beam fitted with multiple clamps.

**Option:**

- Higher WLL available upon request.
- Adjustable jaw opening available from: 0 to 155 mm.

**Norm:**

- EN12100-1/2, EN13155, AS4991, ASME-B30,20

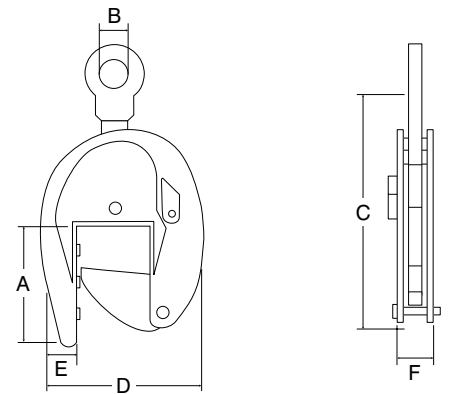

Type	WLL (kg)	Jaw opening (mm)	A (mm)	B (mm)	C (mm)	D (mm)	E (mm)	F (mm)	Weight (kg)	ProductId
CBL-1.5	1500	0-80	205	70	520	280	66	64	20	3313017

**CDK fluted sheet lifting clamps**



**Properties:**

- Capacity 3000 kg per pair.
- Always apply these clamps per pair.

**Application**

- Specifically developed for safe lifting and transportation fluted plates of dams. These clamps must always be used in pairs.

**Norm:**

- EN12100-1/2, EN13155, AS4991, ASME-B30,20

**Option**

- Schackle (3011011)

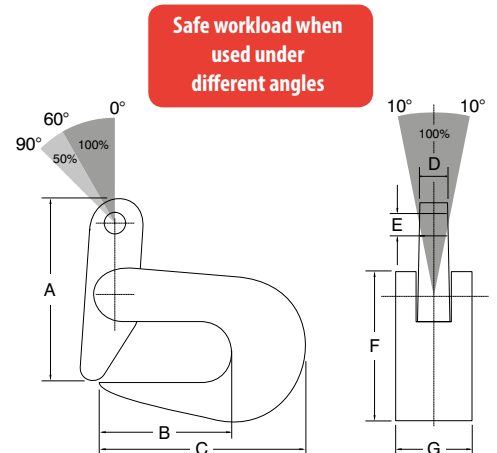

Type	WLL/pair (kg)	Jaw opening (mm)	A (mm)	B (mm)	C (mm)	D (mm)	E (mm)	F (mm)	G (mm)	Weight/pair (kg)	ProductId
CDK-3.0	3000/2	0 - 20	185	80	140	15	25	115	40	7.6	3313023

**CRC rail clamp**



**Properties**

- Lifting capacity and jaw opening are clearly engraved on the housing.
- Equipped with a safety mechanism that prevents the rail from sliding out of the jaw during lifting.
- The clamp locks in open and closed position.

**Applications**

- For vertical transport of (railway) rail profiles.

**Option**

- Other capacities and jaw opening.
- Other profile dimensions on request.

**Norm:**

- EN12100-1/2, EN13155, AS4991, ASME-B30,20

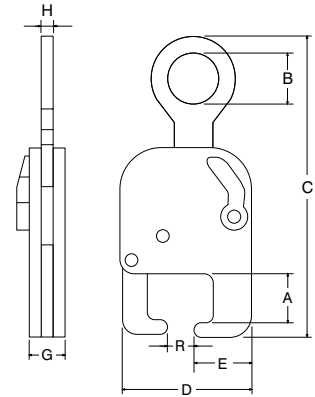

Type	WLL (kg)	Jaw opening R (mm)	A (mm)	B (mm)	C (mm)	D (mm)	E (mm)	G (mm)	H (mm)	Weight (kg)	ProductId
CRC-1.5	1500	40-75	64	65	390	170	70	48	16	8	3314015

**CPH pipe lifting clamps**



**Properties**

- Jaw is covered with a special high quality pressure resistant plastic.
- These clamps must always be used in pairs.
- Exclusive fasteners.

**Application**

- For horizontal lifting and transporting of steel and concrete pipes without damaging the product.

**Norm:**

- EN12100-1/2, EN13155, AS4991, ASME-B30,20

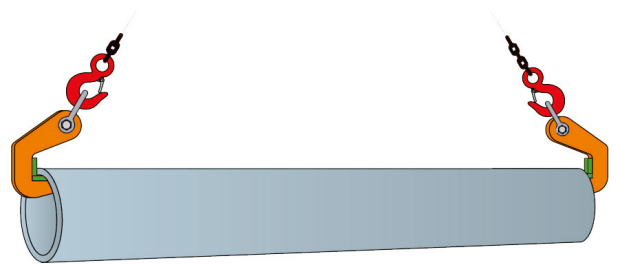
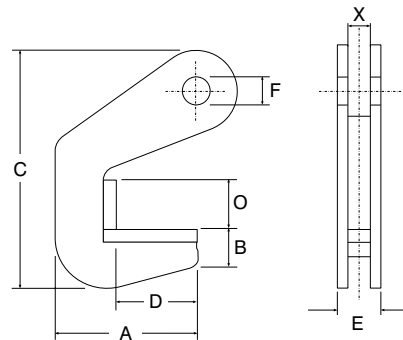

Type	WLL/pair (kg)	Jaw opening O (mm)	A (mm)	B (mm)	C (mm)	D (mm)	E (mm)	F (mm)	X (mm)	Weight/pair (kg)	ProductId
CPH-1.5	1500/2	40	120	32	185	70	41	16	23	3.2/2	3313025
CPH-3.0	3000/2	40	120	32	185	70	41	16	23	3.2/2	3313027
CPH-4.0	4000/2	50	140	58	180	70	41	26	23	6.0/2	3313029
CPH-6.0	6000/2	50	140	58	180	70	41	26	23	6.0/2	3313031
CPH-8.0	8000/2	70	140	58	200	70	45	26	25	7.2/2	3313033
CPH-10.0	10000/2	70	140	58	200	70	86	26	44	10.0/2	3313034
CPH-12.0	12000/2	70	140	58	200	70	86	26	44	12.0/2	3313035
CPH-15.0	15000/2	70	155	75	250	70	100	26	59	18.0/2	3313037
CPH-20.0	20000/2	70	155	75	250	70	100	26	59	20.0/2	3313039

**CRK tube lifting clamps**



**Properties**

- For horizontal lifting and transporting of tubes, pipes, tube bundles, rolls and other solid round materials
- The clamp is locked in the open position.
- To perform lifting, the operator must lift the handle while the force on the lifting eye is being applied.
- When laying down the load, the clamp automatically opens.

**Norm:**

- EN12100-1/2, EN13155, AS4991, ASME-B30,20

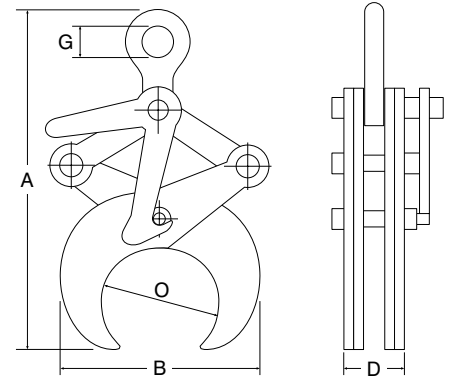

Type	WLL (kg)	Jaw opening (O) min-max (mm)	A min-max (mm)	B min-max (mm)	D (mm)	G (mm)	Weight (kg)	ProductId
CRK-0.5	500	49-114	300-400	215	47	45	4.5	3311001
CRK-1.0	1000	114-219	470-560	345	51	45	9.0	3311003
CRK-2.0	2000	219-368	754-870	610	60	65	31.0	3311005
CRK-3.0	3000	368-508	840-1100	770	60	65	39.0	3311007

**CBKN block lifting clamps**



**Properties**

- 2 special synthetic anti-friction pads to guarantee non-marking.
- Lightweight design and easy to use.
- Tough quality heavy duty body.
- Maintenance-friendly, easy to exchange parts which are available upon request.

**Application**

- For vertical lifting and transporting of all plates, blocks and structures with parallel sides without marking, scratching and or damaging the material surface.
- Perfect for lifting materials such as (stainless) steel, aluminum, nature stone, composite, painted materials, wood, glass, plastic, etc.
- The clamp is locked in the open position.

**Norm:**

- EN12100-1/2, EN13155, AS4991, ASME-B30,20

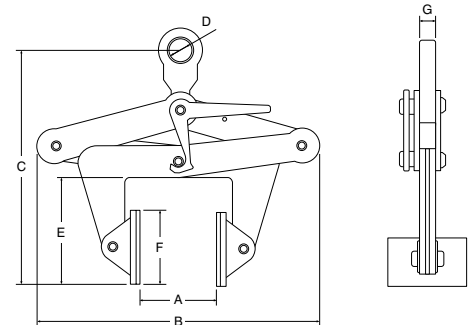

Type	WLL (kg)	Jaw opening (mm)	B (mm)	C (mm)	D (mm)	E (mm)	F (mm)	G (mm)	Weight (kg)	ProductId
CBKN-0.5	500	30-110	270-325	305-460	45	100	80 x 70	15	7	3312013
CBKN-1.0	1000	100-230	425-530	380-655	45	140	80 x 70	15	12	3312015
CBKN-2.0	2000	220-360	580-675	410-735	45	170	80 x 70	16	18	3312017
CBKN-3.0	3000	350-500	725-835	530-900	65	200	100 x 90	20	32	3312019

## PU-10 pallet puller



### Properties

- Single clippers with wider jaw openings.

### Application

- Suitable for wooden pallets and crates.

Type	WLL (kg)	Jaw opening (mm)	Length (mm)	Weight (kg)	ProductId
PU10	2200	90	760	9,5	3260010

## PU-20 pallet puller



### Properties

- Single clippers with wider jaw openings.

### Application

- Suitable for wooden pallets and crates.

Type	WLL (kg)	Jaw opening (mm)	Length (mm)	Weight (kg)	ProductId
PU20	2200	190	495	5,5	3260020

## PU-30 pallet puller



Single clippers with wider jaw openings.  
Suitable for wooden pallets and crates.

### Properties

- For maximum grip with handle for easy positioning.

### Application

- Suitable for wooden and steel pallets and crates.

Type	WLL (kg)	Jaw opening (mm)	Length (mm)	Weight (kg)	ProductId
PU30	2200	110	390	6,5	3260030

## Special clamps



REMA grabs are available in many versions and can be used for transferring and loading all kinds of goods such as:

**Applications:**

- bales
- beams
- blocks
- cylinders
- crates
- sheets
- profiles
- rolls
- drums
- bags