

Comparison list hand chain hoist	4
REMA C-21 Hand chain hoist	5
Elephant Hand chain hoist	6
Elephant PIH/H100 Cleanroom hand chain hoist	8
REMA RIH Stainless steel hand chain hoist	9
REMA Select 200 Hand chain hoist	10
REMA X-Line Hand chain hoist	12
REMA X-line Black line hand chain hoist	13
REMA S20 Hoist/Trolley combination	14
KBT 200 OD low headroom hoist-trolley	16



Manual hoist selection chart



REMA C-21

Very low weight, compact design and high quality.

Main features

General purpose. Ideal for industrial uses and installation work.

500 kg - 5.000 kg

Page 5



Elephant H100

Chain hoist featuring precision bearings.

Main features

Suitable for very intensive use in the offshore industry and heavy industry.

500 kg - 5.000 kg

Page 6



REMA Select 200

Designed with overload protection to lower the load safely in the event of overloading.

Main features

Safe working. Protects both the hoist and the structure against undesirable overloading. >10 T no overload protection

250 kg - 30.000 kg

Pages 10-11



REMA X-line

Identical to the Select 200-OD, but without the overload protection.

Main features

Equivalent to the Select 200-OD, but without the overload protection.

250 kg - 10.000 kg

Page 12

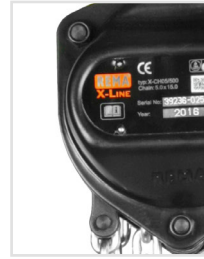

REMA BLACK-line

Identical to the X-line, but a black version.

Main features

Suitable for theatre; made with a black body and top and bottom hooks.

250 kg - 500 kg

Page 13



Hoistman mini-hoist

A high-quality, lightweight hand chain hoist available in 150 kg and 250 kg versions.

Main features

Due to its low weight of 3 kg, ideal for installation and assembly work.

150 kg - 250 kg

Page 7

Clean room manual hoists



Elephant H100 PIH

Same as the H100; suitable for clean rooms due to specific adaptations.

Main features

Chrome-plated caps; side plates, load chain, top and bottom hooks nickel-plated.

500 kg - 2.000 kg

Page 8



REMA RIH

Manual chain hoist made entirely of stainless steel; body, hooks and chain.

Main features

Suitable for the foodstuffs and chemicals industries, water boards etc.

500 kg - 1.000 kg

Page 9



REMA S20P

Select 200 OD hand chain hoist fully integrated with a matching push trolley.

Main features

For a low construction height where a greater hoisting height is required. Can be moved by pushing the load.

500 kg - 5.000 kg

Page 14



REMA S20G

Select 200 OD hand chain hoist fully integrated with a matching manually-operated push trolley.

Main features

For a reduced building height where a greater hoisting height is required. Can be moved by operating manual chain.

500 kg - 5.000 kg

Page 15



REMA KBT

Special hoist-trolley for extremely low build height applications.

Main features

For a maximum hoisting height in low headroom spaces, such as machine rooms. Can be moved by operating manual chain.

1.000 kg - 6.300 kg

Page 16

Hoist-trolley combinations

REMA C-21 Hand chain hoist



Safety factor of at least 4.8 or higher. Very compact and light body, 5.5 kg 0.5 ton, easy to carry. Strong and dimensionally stable house made of high-quality metal. Durable brake discs guarantee a longer service life. The strongest hoist load chain B39VH, Grade 10. High-quality solid forged hooks with a strong and stable safety latches for even greater safety.

Properties

- Light and compact design.
- Galvanized load chain with high tensile strength, Grade 10.
- Galvanized hand chain.
- Reliable load pressure brake that holds the load at any desired height.
- Patented guide for the load chain.
- Double pawl spring for extra safety.
- Safety latches on top and bottom hook.

Standard delivery

- 3 meters lifting height (max. between top and bottom hook).
- 2.5 meters operating height.

Option

- Available in any other lifting and operational heights.

Norm:

- EN12100-1/2, EN13157, EN818-7

C-21/500 - C-21/2000

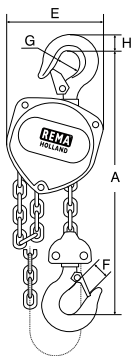

C-21/3000

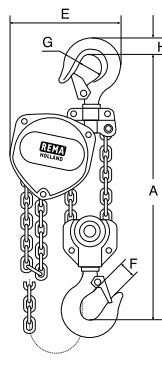

C-21/5000

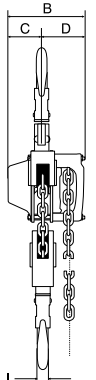
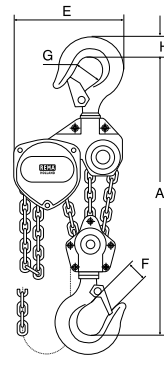

Type	WLL (kg)	Hand force max. (kg)	Load chain (mm)	Number of falls	Operating chain (mm)	Construction height (mm)	Weight (kg)	ProductId
C21-500KG	500	26	4,3 x 12	1	4,5 x 23	275	5,5	0021001
C21-1000KG	1.000	32	5,6 x 17	1	4,5 x 23	310	8,9	0021003
C21-1500KG	1.500	33	6,5 x 19	1	4,5 x 23	340	12,6	0021005
C21-2000KG	2.000	33	7,5 x 21	1	4,5 x 23	384	16,6	0021007
C21-3000KG	3.000	38	6,5 x 19	2	4,5 x 23	480	19,3	0021009
C21-5000KG	5.000	34	7,5 x 21	3	4,5 x 23	555	34,0	0021011

Type	A (mm)	B (mm)	C (mm)	D (mm)	E (mm)	F (mm)	G (mm)	H (mm)	I (mm)
C21-500KG	275	131	54	77	121	24	36	17	13
C21-1000KG	310	143	61	82	148	29	43	22	16
C21-1500KG	340	152	68	84	168	29	43	26	21
C21-2000KG	384	164	75	89	193	34	53	29	22
C21-3000KG	480	152	68	84	209	36	53	35	28
C21-5000KG	555	164	75	89	297	45	70	46	34

Elephant H100 Hand chain hoist

The Elephant H100 is a robust hand chain hoist for heavy and very intensive use where safety, ergonomics and little operating effort is required.

Properties

- Low operating force at maximum load due roller bearings.
- Double pawls with double springs supporting fail-safe brake mechanism.
- Self-locking brake holds the load at any desired height.
- Safety latches on top and bottom hooks.
- Rolled-edge hand wheel cover to provide smooth operation of the hand chain when pulled sideways.
- In case of overload, the hooks will gradually bend and do not suddenly break off.
- Patented chain guide for the load chain to allow smooth operation.
- Galvanized load chain Grade 10.
- Galvanized hand chain.

Standard delivery

- 3 meters lifting height (max. between top and bottom hook).
- 2.5 meters operating height.

Option

- Available in any other lifting and operational heights.

Norm:

- EN12100-1/2, EN13157, EN818-7

0.5 - 2.0 t

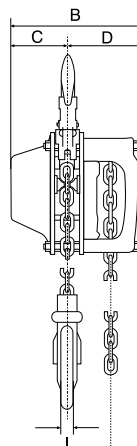
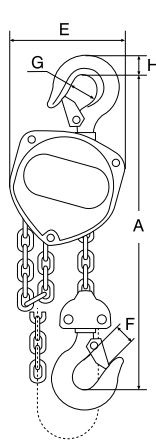

3.1 - 5.0 t

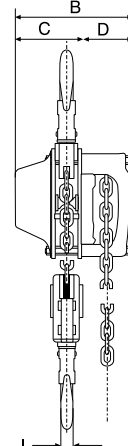
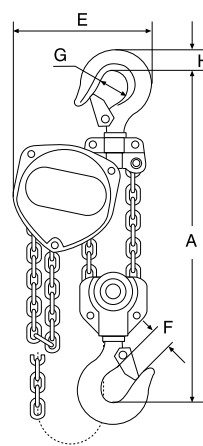

Type	WLL (kg)	Hand force max. (kg)	Load chain (mm)	Number of falls	Operating chain (mm)	Construction height (mm)	Weight (kg)	ProductId
H100-500KG	500	22	5,0 x 15,0	1	5,0 x 23,6	277	9	0100001
H100-1000KG	1.000	26	6,3 x 19,1	1	5,0 x 23,6	303	11.4	0100003
H100-1600KG	1.600	34	7,1 x 21,0	1	5,0 x 23,6	338	14.7	0100005
H100-2000KG	2.000	34	8,0 x 24,2	1	5,0 x 23,6	379	21	0100007
H100-3100KG	3.100	36	7,1 x 21,0	2	5,0 x 23,6	516	24	0100009
H100-5000KG	5.000	36	9,0 x 27,2	2	5,0 x 23,6	613	39.5	0100011

Type	A (mm)	B (mm)	C (mm)	D (mm)	E (mm)	F (mm)	G (mm)	H (mm)	I (mm)
H100-500KG	277	155	65	90	140	26	36	17	13
H100-1000KG	303	160	69	91	160	30	43	22	16
H100-1600KG	338	167,5	75	92.5	183	35	48	27	20
H100-2000KG	379	183	83	100	215	38	53	29	22
H100-3100KG	516	167,5	75	92.5	230	44	60	37	27
H100-5000KG	613	190	90	100	282	53	70	46	34

Elephant HOISTMAN



The Elephant HOISTMAN is a lightweight mini-hand chain hoist.
Very compact for use in confined spaces and where a low self weight is desirable.

Properties

- Light and compact.
- Low operating effort at maximum load through planetary gears.
- Safety latches on top and bottom hook.
- Body plating in golden colour powder painting.
- Galvanized load chain (Grade 10).
- Galvanized hand chain.

Standard delivery

- 2,5 meters lifting height (max. between top and bottom hook).
- 2 meters operating height.

Norm:

- EN12100-1/2, EN13157, EN818-7

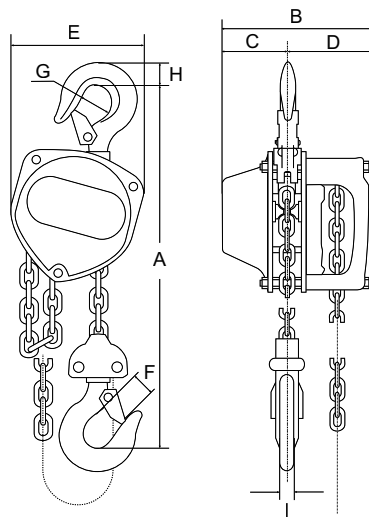

Only weighs
2,8 kg
2,5 meter Lifting

Type	WLL (kg)	Hand force max. (kg)	Load chain (mm)	Number of falls	Operating chain (mm)	Construction height (mm)	Weight (kg)	ProductId
HOISTMAN-150KG	150	17	3.1 x 9.3	1	2.5 x 14.0	220	2.8	0100000
HOISTMAN-250KG	250	20	3.1 x 9.3	1	2.5 x 14.0	220	2.8	0100002

Type	A (mm)	B (mm)	C (mm)	D (mm)	E (mm)	F (mm)	G (mm)	H (mm)	I (mm)
HOISTMAN-150KG	220	103	46	57	102	14	24	11	9
HOISTMAN-250KG	220	103	46	57	102	14	24	11	9

Elephant PIH/H100 Cleanroom hand chain hoist



The Elephant PIH / H100 cleanroom manual chain hoist is a robust hoist that is suitable for use in clean rooms.

Properties

- Cover chrome-plated.
- Side plates nickel plated.
- Top and bottom hooks nickel plated and have safety latches.
- In case of overload, the hooks will gradually bend and do not suddenly break off.
- Nuts and base discs of stainless steel.
- Hand chain made of stainless steel.
- Load chain nickel plated.

Standard delivery

- 3 meters lifting height (max. between top and bottom hook).
- 2.5 meters operating height.

Options

- Available in any other lifting and operational heights.
- By using Stainless steel load- and hand chain, they can be used in food industry.

Norm:

- EN12100-1/2, EN13157, EN818-7

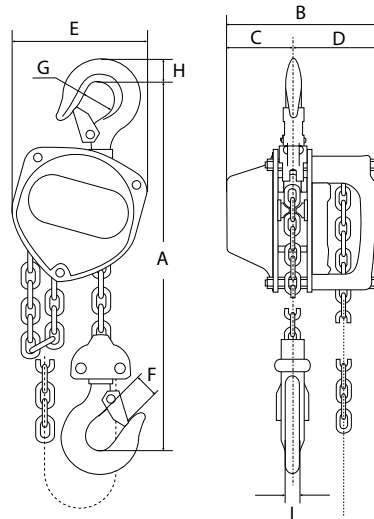

Type	WLL (kg)	Hand force (kg)	Load chain (mm)	Number of falls	Operating chain (mm)	Construction height (mm)	Weight (kg)	ProductId
PIH/H100-500KG	500	22,0	5,0 x 15,0	1	5,0 x 23,6	277	9	0100201
PIH/H100-1000KG	1.000	25,5	6,3 x 19,1	1	5,0 x 23,6	303	11,5	0100203
PIH/H100-2000KG	2.000	34,0	8,0 x 24,2	1	5,0 x 23,6	379	21,0	0100207

Type	A (mm)	B (mm)	C (mm)	D (mm)	E (mm)	F (mm)	G (mm)	H (mm)	I (mm)
PIH/H100-500KG	277	155	65	90	140	26	36	17	13
PIH/H100-1000KG	303	160	69	91	160	30	43	22	16
PIH/H100-2000KG	379	183	83	100	215	38	53	29	22

REMA RIH stainless steel hand chain hoist



The Rema RIH hand hoist is a robust manual chain hoist made entirely of stainless steel, which is suitable for use in the food industry or other environments where there is high humidity and there is sensitivity to corrosion.

Properties

- Suitable for highly corrosive environments or dust-free rooms - clean room environment
- Maximum protection against corrosion
- Load and hand chain AISI 316
- Cover caps AISI 304
- Stainless steel components
- Hooks and load chain wheel, plates: AISI 304
- Electrolytically polished surface.

Standard delivery

- 3 meters lifting height (max. between top and bottom hook).
- 2.5 meters operating height.

Options

- Available in any other lifting and operational heights.
- Stainless steel trolley.

Norm:

- EN12100-1/2, EN13157, EN818-7

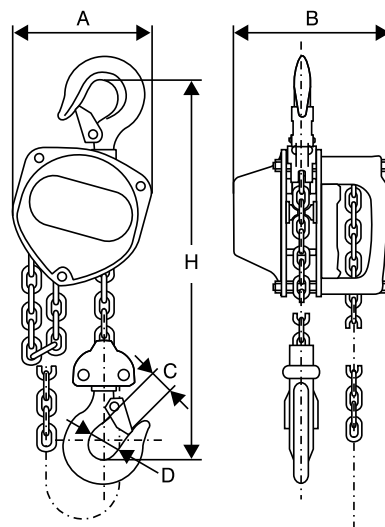

**Complete
Stainless steel
AISI 316/304**

Type	WLL (kg)	Hand force (kg)	Load chain (mm)	Number of falls	Operating chain (mm)	Construction height (mm)	Weight (kg)	ProductId
RIH-500	500	22,0	6,3 x 19,0	1	5,0 x 23,3	355	12,5	0110001
RIH-1000	1.000	25,5	7,9 x 23,0	1	5,0 x 23,3	425	20,5	0110003

Type	A (mm)	B (mm)	C (mm)	D (mm)	H (mm)
RIH-500	150	140,0	Ø35	27	355
RIH-1000	193	162,4	Ø43	32	425

REMA Select 200 Hand chain hoist



The REMA Select 200 OD is equipped with an overload protection from 500 kg. It is a robust manual chain hoist for heavy and intensive use where safety, ergonomics and a low operating effort are paramount.

Properties

- The new innovative overload protection ensures an improved safer operation of the hoist.
- Overload device system makes it possible to lower the load in a controlled way.
- Equipped with a double pawl system.
- Brake is provided with asbestos free friction discs.
- Top and bottom hooks are equipped with a robust latches.
- Load hooks gradually bend and do not break off suddenly.
- Galvanized load chain Grade 8.
- Galvanized hand chain.
- * = without overload device.

**Overload Device
provides
more safety**

**Except 250 kg*

Standard delivery

- 3 meters lifting height (max. between top and bottom hook).
- 2.5 meters operating height.
- Overload protection from 500 kg up to 10.000 kg.

Norm:

- EN12100-1/2, EN13157, EN818-7

Option

- Available in any other hoisting and operational heights.
- Chain bag available up to 10 meter lifting height from 500 kg till 2000 kg.
- Short height in combination with REMA 211/212 trolley. (500/1000/2000 kg).



0.25t - 2.0t

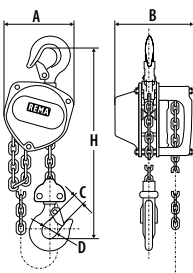

3.0t - 5.0t

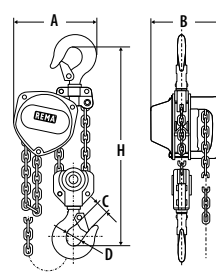

7.5t

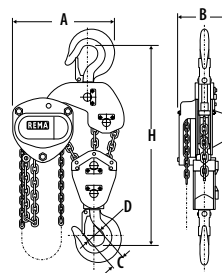

10t

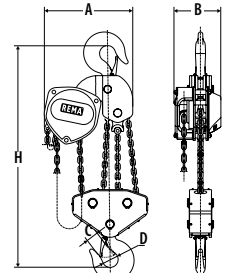

* = without overload protection.

Type	WLL (kg)	Hand force max. (kg)	Load chain (mm)	Number of falls	Operating chain (mm)	Construction height (mm)	Weight (kg)	ProductId
S200-250KG*	250	23.5	4.0 x 12.0	1	5.0 x 23.7	260	6.0	0120000
S200OD-500KG	500	24.9	5.0 x 15.0	1	5.0 x 23.7	280	9.0	0120001
S200OD-1000KG	1.000	28.4	6.3 x 19.0	1	5.0 x 23.7	330	12.0	0120003
S200OD-1500KG	1.500	30.8	7.1 x 21.0	1	5.0 x 23.7	360	16.0	0120005
S200OD-2000KG	2.000	34.3	8.0 x 24.0	1	5.0 x 23.7	385	20.0	0120007
S200OD-3000KG	3.000	34.3	7.1 x 21.0	2	5.0 x 23.7	510	24.0	0120009
S200OD-5000KG	5.000	37.2	9.0 x 27.0	2	5.0 x 23.7	615	37.0	0120011
S200OD-7500KG	7.500	36.8	9.0 x 27.0	3	5.0 x 23.7	690	62.0	0120013
S200OD-10000KG	10.000	40.0	9.0 x 27.0	4	5.0 x 23.7	820	104.6	0120015

Type	A (mm)	B (mm)	C (mm)	D (mm)	H (mm)
S200-250KG*	108	106	20	30	260
S200OD-500KG	130	128	22	34	280
S200OD-1000KG	150	142	26	39	330
S200OD-1500KG	170	158	29	42	360
S200OD-2000KG	185	175	35	49	385
S200OD-3000KG	220	158	37	50	510
S200OD-5000KG	255	183	43	60	615
S200OD-7500KG	430	189	47	67	690
S200OD-10000KG	360	183	47	65	820

REMA Select 200 Hand chain hoist (high capacities)



The REMA Select 200 is a robust manual chain hoist for heavy and intensive use where safety, ergonomics and a low operating effort are paramount.

Properties

- Equipped with a double pawl system.
- Brake is provided with asbestos free friction discs.
- Safety latches on top and bottom hook.
- In case of overload, the hooks will gradually bend and do not suddenly break off.
- Galvanized load chain Grade 8.
- Galvanized hand chain.

Standard delivery

- 3 meters lifting height (max. between top and bottom hook).
- 2.5 meters operating height.
- Exclusive overload protection.

Option

- Available in any other lifting and operational heights.

Norm:

- EN12100-1/2, EN13157, EN818-7

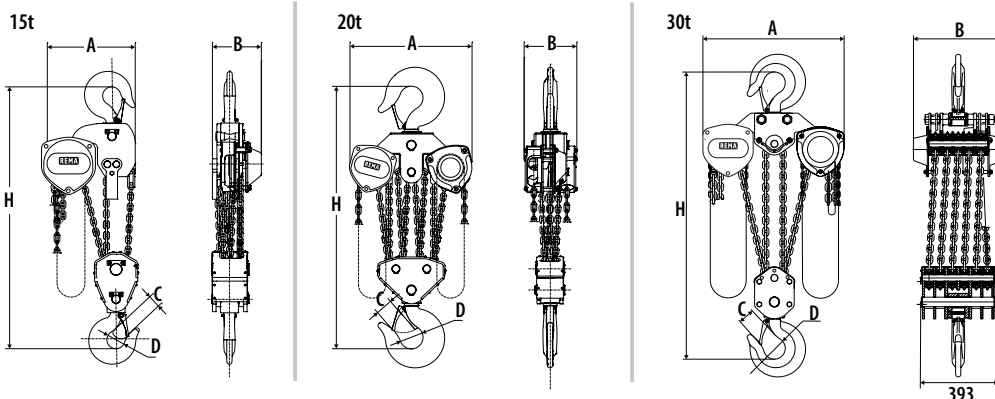

Type	WLL (kg)	Hand force max. (kg)	Load chain (mm)	Number of falls	Operating chain (mm)	Construction height (mm)	Weight (kg)	ProductId
S200-15000KG	15.000	40.0	9.0 x 27.0	6	5.0 x 23.7	920	162.6	0120017
S200-20000KG	20.000	40.0	9.0 x 27.0	8	5.0 x 23.7 (2x)	1060	200.0	0120019
S200-30000KG	30.000	40.0	10.0 x 28.0	12	5.0 x 23.7 (2x)	1450	200.0	0120021

Type	A (mm)	B (mm)	C (mm)	D (mm)	H (mm)
S200-15000KG	386	183	62	77	920
S200-20000KG	577	183	75	90	1060
S200-30000KG	710	452	85	110	1450

REMA X-Line Hand chain hoist



The REMA X-Line hand chain hoist is a robust and ergonomic hoist for intensive use.

Properties

- Low operating force at full load.
- Increased operational safety due to double pawl system.
- Brake is provided with asbestos-free friction discs.
- Load chain wheel is made of wear-resistant alloy steel.
- Safety latches on top and bottom hook.
- In case of overload, the hooks will gradually bend and do not abruptly break off.
- Galvanized load chain (Grade 8).
- Galvanized hand chain.
- Steel housing with orange colored powder coating.

Standard delivery

- 3 meters lifting height (max. between top and bottom hook).
- 2.5 meters operating height.

Option

- Available in any other hoisting and operational heights.

Norm:

- EN12100-1/2, EN13157, EN818-7

0.25t - 2.0t

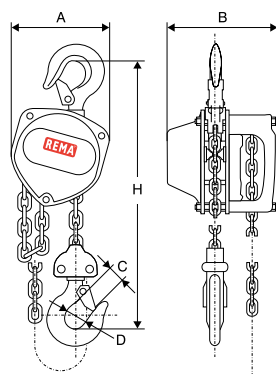

3.0t - 5.0t

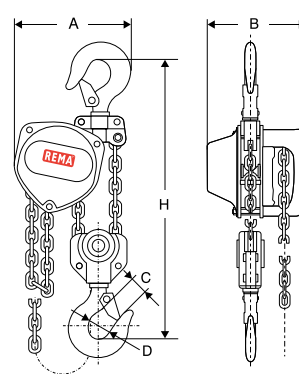

10t

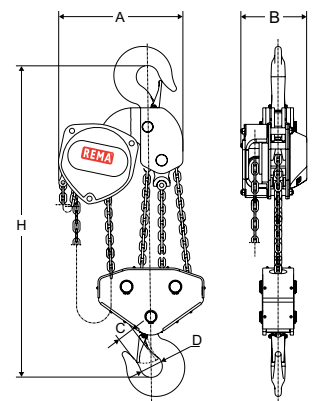

Type	WLL (kg)	Hand force max. (kg)	Load chain (mm)	Number of falls	Operating chain (mm)	Construction height (mm)	Weight (kg)	ProductId
X-CH025/250KG	250	23.5	4.0 x 12.0	1	5.0 x 23.7	260	6.0	0170000
X-CH05/500KG	500	24.9	5.0 x 15.0	1	5.0 x 23.7	280	9.0	0170001
X-CH10/1000KG	1000	28.4	6.3 x 19.0	1	5.0 x 23.7	330	12.0	0170003
X-CH15/1500KG	1500	30.8	7.1 x 21.0	1	5.0 x 23.7	360	16.0	0170005
X-CH20/2000KG	2000	34.3	8.0 x 24.0	1	5.0 x 23.7	385	20.0	0170007
X-CH30/3000KG	3000	34.3	7.1 x 21.0	2	5.0 x 23.7	510	24.0	0170009
X-CH50/5000KG	5000	37.2	9.0 x 27.0	2	5.0 x 23.7	615	37.0	0170011
X-CH100/10000KG	10000	40.0	9.0 x 27.0	4	5.0 x 23.7	820	104.6	0170015

Type	A (mm)	B (mm)	C (mm)	D (mm)	H (mm)
X-CH025/250KG	108	106	20	30	260
X-CH05/500KG	130	128	22	34	280
X-CH10/1000KG	150	142	26	39	330
X-CH15/1500KG	170	158	29	42	360
X-CH20/2000KG	185	175	35	49	385
X-CH30/3000KG	220	158	37	50	510
X-CH50/5000KG	255	183	43	60	615
X-CH100/10000KG	360	183	47	65	820

REMA X-line Black line hand chain hoist

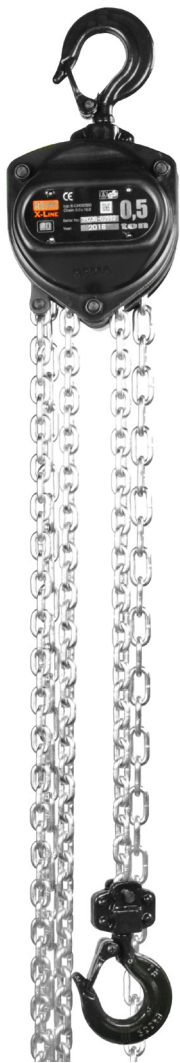

The REMA BLACKLINE hand chain hoist is suitable for theater purposes where safety, ergonomics and a low operating effort are paramount. The body and hooks are coloured black to limit visibility in sensitive dark environments.

Properties

- Low operating effort at full load.
- Increased operational safety due to double pawl system.
- Load pressure brake with asbestos free friction discs.
- Load chain wheel is made of wear-resistant alloy steel.
- Safety latches on top and bottomhook.
- In case of overload, the hooks will gradually bend and do not suddenly break off.
- Galvanized load chain (Grade 8).
- Galvanized hand chain.

Standard delivery

- Lifting height 10 or 15 meters

Option

- Other lifting heights on request.
- chain bag for load chain up to 10 meters lifting height.

Norm:

- EN12100-1/2, EN13157, EN818-7

250-500 kg

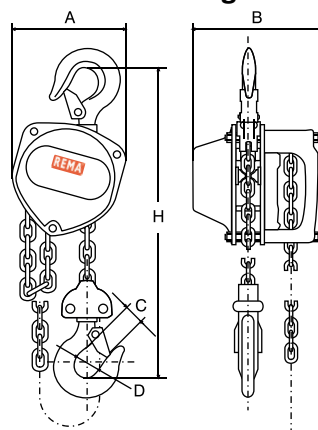

Option

Type	WLL (kg)	Hand force max. (kg)	Load chain (mm)	Number of falls	Operating chain (mm)	Construction height (mm)	Weight (kg)	ProductId
X-LINE/250KG/BLACK	250	23.5	4.0 x 12.0	1	5.0 x 23.7	280	6.0	0171000
X-LINE/500KG/BLACK	500	24.9	5.0 x 15.0	1	5.0 x 23.7	280	9.0	0171001

Type	A (mm)	B (mm)	C (mm)	D (mm)	H (mm)
X-LINE/250KG/BLACK	108	106	20	30	280
X-LINE/500KG/BLACK	130	128	22	34	280

S20P Low headroom Hoist/Push trolley combination



These low headroom hoist-trolley combinations are only supplied with REMA Select 200OD hand chain hoist.

Properties

- Low headroom.
- Push trolley.
- Technical detail hand chain hoist, see Select 200OD.
- Tilting and anti-drop protection for additional safety.
- Suitable for attachment to various I-beams and H-beams.

Standard delivery

- Included trolley.
- 3 meters lifting height.
- 2.5 m operating height.

Option

- Available in other lifting and operating height on request.

Norm:

- EN12100-1/2, EN13157, EN818-7

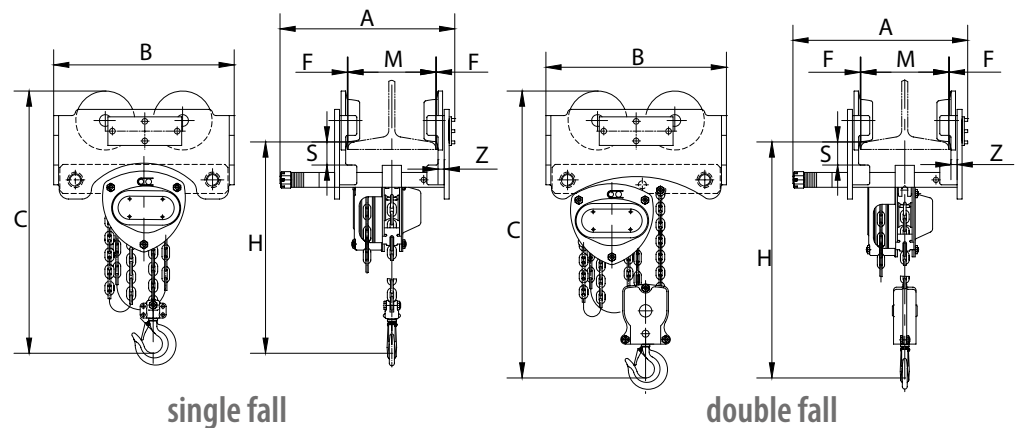

single fall

double fall

Type	WLL (kg)	Number of falls	Flange width (mm)	Min. radius (mm)	Load chain (mm)	Operating chain (mm)	Weight (kg)	ProductId
S20P/200OD-0.5	500	1	50-203	800	5,0 x 15,0	5.0 x 23.7	55	0930001
S20P/200OD-1.0	1.000	1	64-305	900	6,3 x 19,1	5.0 x 23.7	68	0930003
S20P/200OD-1.5	1.500	1	74-305	1000	7,1 x 21,0	5.0 x 23.7	80	0930005
S20P/200OD-2.0	2.000	1	88-305	1000	8.0 x 24.0	5.0 x 23.7	80	0930007
S20P/200OD-3.0	3.000	2	100-305	1200	7,1 x 21,0	5.0 x 23.7	100	0930009
S20P/200OD-5.0	5.000	2	114-305	1300	9.0 x 27.0	5.0 x 23.7	110	0930011

Type	A (mm)	B (mm)	Cmin (mm)	F (mm)	Hmin (mm)	M (mm)	S (mm)	Z (mm)
S20P/200OD-0.5	265	258	310.5	1.5~3	243.5	50-203	30	9
S20P/200OD-1.0	385	292	420	1.5~3	340	64-305	37	8
S20P/200OD-1.5	396	360	460	1.5~3	380	74-305	39	10
S20P/200OD-2.0	396	360	500	1.5~3	405	88-305	38	10
S20P/200OD-3.0	407	430	590	1.5~3	475	100-305	42	12
S20P/200OD-5.0	420	420	725	1.5~3	610	114-305	41.5	16

S20G Low headroom hoist/geared trolley combination



These low headroom hoist-trolley combinations are only supplied with REMA Select 2000D hand chain hoist.

Properties

- Low headroom.
- Operating with hand chain.
- Technical detail hand chain hoist, see Select 2000D.
- Tilting and anti-drop protection for additional safety.
- Suitable for attachment to various I-beams and H-beams.

Standard delivery

- Including hand operated trolley.
- 3 meters lifting height.
- 2.5 m operating height.

Option

- Any other hoisting height and operating height is also possible.

Norm:

- EN12100-1/2, EN13157, EN818-7

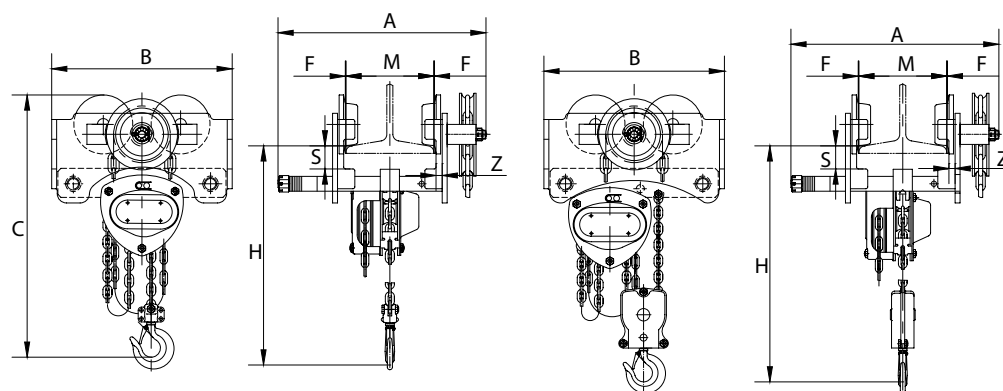

single fall

double fall

Type	WLL (kg)	Number of falls	Flange width (mm)	Min. radius (mm)	Load chain (mm)	Operating chain (mm)	Weight (kg)	ProductId
S20G/2000D-0.5	500	1	50-203	800	5,0 x 15,0	5,0 x 23,7	55	0931001
S20G/2000D-1.0	1.000	1	64-305	900	6,3 x 19,1	5,0 x 23,7	68	0931003
S20G/2000D-1.5	1.500	1	74-305	1000	7,1 x 21,0	5,0 x 23,7	80	0931005
S20G/2000D-2.0	2.000	1	88-305	1000	8,0 x 24,0	5,0 x 23,7	80	0931007
S20G/2000D-3.0	3.000	2	100-305	1200	7,1 x 21,0	5,0 x 23,7	100	0931009
S20G/2000D-5.0	5.000	2	114-305	1300	9,0 x 27,0	5,0 x 23,7	110	0931011

Type	A (mm)	B (mm)	Cmin (mm)	F (mm)	Hmin (mm)	M (mm)	S (mm)	Z (mm)
S20G/2000D-0.5	322	258	310.5	1.5~3	243.5	50-203	30	9
S20G/2000D-1.0	435	292	420	1.5~3	340	64-305	37	8
S20G/2000D-1.5	433	360	460	1.5~3	380	74-305	39	10
S20G/2000D-2.0	446	360	500	1.5~3	405	88-305	38	10
S20G/2000D-3.0	459	430	590	1.5~3	475	100-305	42	12
S20G/2000D-5.0	474	447	725	1.5~3	610	114-305	41.5	16

KBT2000D extremely low headroom hoist-trolley



Hand-operated trolley in combination with the REMA Select 200OD hand chain hoist.
Only available in combination with the REMA Select 200 OD manual chain hoist.

Properties

- Extremely low building height (135-235 mm).
- Suitable for I-beams and H-beams.
- Maintenance-free ball bearings.
- Wheel rupture supports for extra safety.
- Hand chain operated trolley.
- Technical specifications for manual hoist see Select 200 OD chain hoist.

Standard delivery

- 3 meters lifting height.
- 2.5 meters operating height.

Option

- Available in other lifting and operating heights.

Norm:

- EN12100-1/2, EN13157, EN818-7

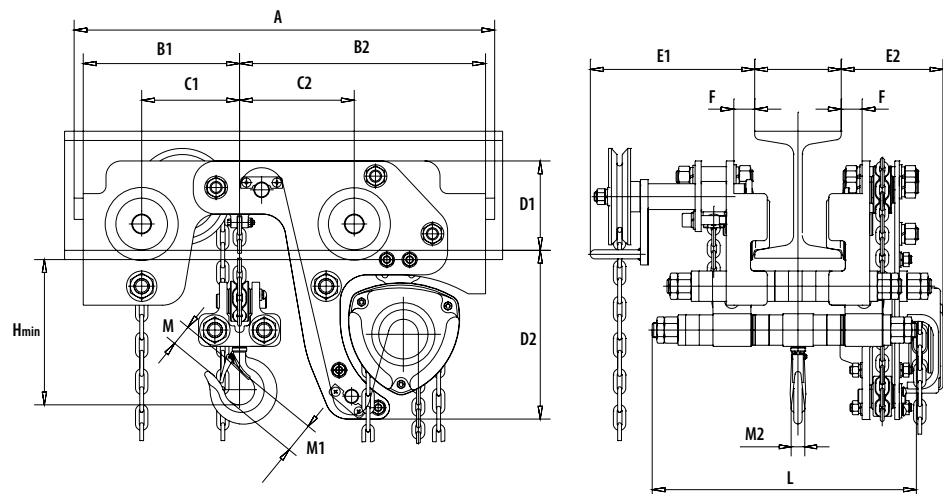

Type	WLL (kg)	Number of falls	Flange width (mm)	Min. radius (mm)	Load chain (mm)	Operating chain (mm)	Weight (kg)	ProductId
KBT2000D-1	1.000	2	74-150	2500	5,0 x 15,0	5,0 x 23,7	69	0923001
KBT2000D-2	2.000	2	82-156	4000	6,3 x 19,1	5,0 x 23,7	118	0923003
KBT2000D-3.2	3.200	2	103-223	4500	8,0 x 24,2	5,0 x 23,7	181	0923005
KBT2000D-5	5.000	4	119-215	6000	8,0 x 24,2	5,0 x 23,7	293	0923007
KBT2000D-6.3	6.300	4	119-215	6000	8,0 x 24,2	5,0 x 23,7	296	0923009

Type	A (mm)	B1 (mm)	B2 (mm)	C1 (mm)	C2 (mm)	D1 (mm)	D2 (mm)	E1 (mm)	E2 (mm)	F (mm)	H (mm)	L (mm)	M1 (mm)	M2 (mm)
KBT2000D-1	554	206	234	129	151	117	223	217	134	27,5	135	348	40	18
KBT2000D-2	684	254	406	149	211	165	265	240	152	36,5	160	392	50	24
KBT2000D-3.2	765	279	461	169	236	165	325	240	173	44,0	190	499	55	28
KBT2000D-5	873	336	524	201	279	184	327	259	180	39,0	235	512	65	37
KBT2000D-6.3	873	336	524	201	279	184	327	259	180	39	235	512	65	37