

## RZ sheaves, unsupported

---

### Product information



### Properties

- Suitable for hand and mechanical applications.
- Maintenance-free design.
- Steel.
- Self-lubricating bearings

... [Read more](#)

---

**Marking:** According to standard, CE-marked  
**Standard:** EN 12100, EN 13157

## RZ sheaves, unsupported

### Blueprint

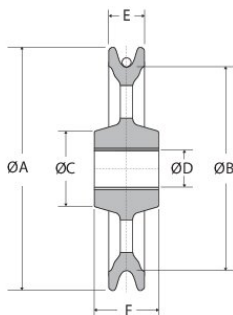

### Technical data

Part code	GTIN No.	Rope Ø range mm	WLL	Model	Max shaft load kg	A mm	B mm	C mm	D mm	E mm	F mm	Weight
3063001	8717365025570	5-6	0.25	RZ-0.5	0,5	150	125	46	22	22	40	2.3
3063003	8717365025587	8-10	0.5	RZ-1.0	1	235	200	78	40	32	50	6
3063005	8717365025594	12-14	1	RZ-2.0	2	325	280	108	60	41	70	16
3063007	8717365025600	16-18	1.5	RZ-3.0	3	400	340	110	70	51	87	27