

RGL gear winches

Product information



REMA[®]

Properties

- Construction according to DIN 152.
- Braked design with double pawl system.
- Crank gradually adjustable in length.
- Drum and shafts provided with bearings.
- Freewheel, through protected pawl system.
- Powdercoating RAL 2004.

Standard delivery

- Does not include wire rope.

Option

- Steel wire rope on request with hook and safety latch.

[... Read more](#)

Marking: According to standard, CE-marked
Standard: EN 12100, EN 13157

RGL gear winches

Blueprint

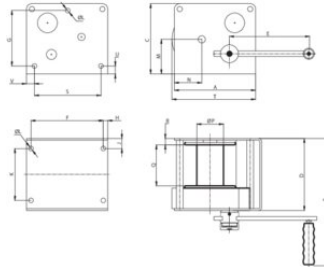

Technical data

Part code	GTIN No.	WLL ton	Model	Rope Ø mm	WLL top layer ton	Gear ratio	Max. reel capacity mm	Length handle mm	Weight kg
2017001	8717365259265	0.15	RGL-150	4	0.045	2.84 :1	22	250/100	9.2
2017003	8717365259272	0.3	RGL-300	5	0.1	6.67:1	30	250/100	16.5
2017005	8717365259289	0.5	RGL-500	6	0.3	7.75 :1	30	250/100	18.5

Model	A	B	C	D	F	G	H	J	K	L	M	N	P	Q	R	S	T	U	V
	mm	mm	mm	mm	mm	mm	mm	mm	mm	mm	mm	mm	mm	mm	mm	mm	mm	mm	mm
RGL-150	180	324	150	150	154														