

## CP-T 400VAC lifting-/pulling winch

### Product information



### Properties:

- Control cable + pushbutton cabinet with emergency stop IP65 included.
- Electronic magnet brake.
- Design with bearing.
- Steel cable + hook included.
- Planetary transmission.

### Technical specifications:

- 400 VAC, 3 Phase, 50 Hz.

... [Read more](#)

**Marking:** According to standard, CE-marked  
**Standard:** EN 12100, EN 14492

## CP-T 400VAC lifting-/pulling winch

### Blueprint

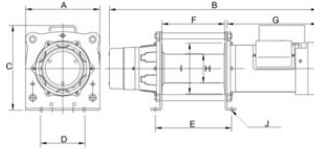

### Technical data

Part code	GTIN No.	WLL ton	Size	Model	Rope Ø mm	Rope length m	Lifting speed first layer m/min.	Drum mm	Pulling capacity t	A mm	B mm	C mm	D mm	E mm	F mm	G mm	H mm	I mm	J mm	Weight kg
2382109	8717365150692	0.5	694 x 260 x 299	CP-T-500	7	60	10	102 x 220	1	260	728	299	156	267	220	316	102	180	6 X 13,5	55