

## CP 230VAC lifting-/pulling winch

---

### Product information



### Properties:

- Control cable + pushbutton cabinet with emergency stop IP65 included.
- Electronic magnet brake.
- Design with bearing.
- Steel cable + hook included.
- Planetary transmission.

### Technical specifications:

- **CP-300** Motor IP44, 4 poles - 1.15 kW.
- **CP-500** Motor IP44, 4 poles - 1.8 kW.
- 230 VAC, 1 Phase, 50 Hz.

[... Read more](#)

---

**Marking:** According to standard, CE-marked  
**Standard:** EN 12100, EN 14492

## CP 230VAC lifting-/pulling winch

### Blueprint

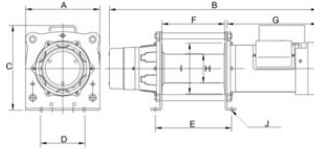

### Technical data

Part code	GTIN No.	WLL ton	Size	Model	Rope Ø mm	Rope length m	Lifting speed first layer m/min.	Drum mm	Pulling capacity t	A mm	B mm	C mm	D mm	E mm	F mm	G mm	H mm	I mm	J mm	Weight kg
2382007	8717365260964	0.3	565 x 210 x 241	CP-300	6	30	10	94 x 110	0,6	210	565	241	142	142	110	280	94	154	6 X 10,5	38
2382009	8717365114151	0.5	694 x 260 x 299	CP-500	7	60	10	102 x 220	1	260	728	299	156	267	220	316	102	180	6 X 13,5	55