

Superclamp A-serie

Product information



Hinged hand trolley with automatic locking.

Properties

- Can be mounted on rails easily and very quickly.
- With wheel fracture support device.
- Maximum beam thickness for type A1=28 mm and A2/A3 = 30 mm.

... [Read more](#)

Marking: According to standard, CE-marked
Standard: EN 12100, EN 13157

Superclamp A-serie

Blueprint

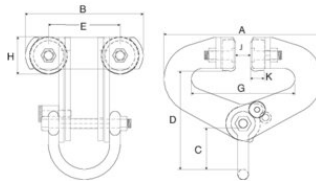

Technical data

Part code	GTIN No.	WLL ton	Beam width mm	Model	A mm	B mm	C mm	D mm	E mm	G mm	H mm	J mm	K mm	Weight kg
3512001	8717365017179	3	76-230	A1	380	280	110	250	170	76-230	82	30	32	21
3512003	8717365017186	6	100-305	A2	500	296	110	290	170	100-305	88	40	38	33
3512005	8717365017193	10	100-305	A3	580	290	135	310	170	100-305	109	40	38	47.5