

## C800X lifting points

---

### Product information



## CARTEC

---

**Marking:** According to standard, CE-marked

**Standard:** EN 1677-1

**Note:** Rotatable through 360°, foldable 180°. Rotates into the correct lifting direction.

**Safety factor:** 4

## C800X lifting points

### Blueprint

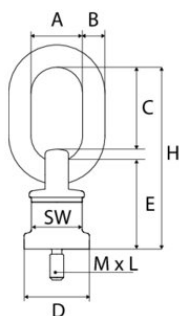

### Technical data

Part code	Code	WLL ton	Thread mm	Model	A mm	B mm	C mm	D mm	E mm	H mm	M x L mm	SW mm	Weight kg
2611108	8717365177873	0.3	M8	C800X-M8x18-0.3T	30	13	46	38	50	105	M8 x 16	30	0.48
2611110	8717365175930	0.5	M10	C800X-M10x18-0.5T	30	13	46	38	50	105	M10 x 18	30	0.48
2611112	8717365175947	0.7	M12	C800X-M12x18-0.7T	30	13	46	38	50	105	M12 x 18	30	0.5
2611116	8717365175954	1.4	M16	C800X-M16x20-1.4T	30	13	46	38	50	105	M16 x 20	30	0.53
2611120	8717365175961	2.5	M20	C800X-M20x30-2.5T	34	16	57	50	61	131	M20 x 30	40	1.05
2611124	8717365175978	4	M24	C800X-M24x30-4.0T	40	18	70	58	68	153	M24 x 30	48	1.63
2611130	8717365175985	6.7	M30	C800X-M30x35-6.7T	45	22	65	80	71	156	M30 x 35	48	2.85
2611136	8717365175992	10	M36	C800X-M36x54-10T	50	23	91	90	86	200	M36 x 54	80	4.62
2611142	8717365176005	12.5	M42	C800X-M42x63-12.5T	50	23	91	90	86	200	M42 x 63	80	5.2
2611148	8717365176012	12.5	M48	C800X-M48x72-12.5T	50	23	91	90	86	200	M48 x 72	80	5.2