

## C-15E DIN-580 Eye bolt type

---

### Product information



The safe working load is only suitable for hoisting and pulling in line.  
The lifting eye must not be loaded sideways.

... [Read more](#)

---

**Material:** C-15E

**Marking:** According to standard, CE-marked

**Standard:** DIN 580

**Note:** Only use in a straight lifting position.

## C-15E DIN-580 Eye bolt type

### Blueprint

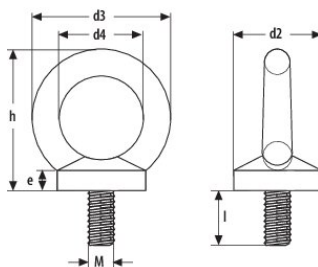

### Technical data

Part code	Code	WLL ton	Thread mm	Model	D2mm mm	D3mm mm	D4mm mm	E mm	H, mm	L mm	Mmm mm	Weight kg
3015101	8717365183522	0.14	M8	DIN580-C15E-M8-140KG	20	36	20	6	36	13	8	0.06
3015103	8717365183539	0.23	M10	DIN580-C15E-M10-230KG	25	45	25	8	45	17	10	0.11
3015105	8717365183546	0.34	M12	DIN580-C15E-M12-340KG	30	54	30	10	53	20.5	12	0.18
3015107	8717365183553	0.49	M14	DIN580-C15E-M14-490KG	35	63	35	12	60	27	14	0.28
3015109	8717365183560	0.7	M16	DIN580-C15E-M16-700KG	35	63	35	12	62	27	16	0.28
3015111	8717365183577	1.2	M20	DIN580-C15E-M20-1200KG	40	72	40	14	71	30	20	0.43
3015113	8717365183584	1.8	M24	DIN580-C15E-M24-1800KG	50	90	50	18	90	36	24	0.84
3015115	8717365183591	2.5	M27	DIN580-C15E-M27-2500KG	50	90	50	18	90	36	27	1.22
3015117	8717365183607	3.2	M30	DIN580-C15E-M30-3200KG	65	108	60	22	109	45	30	1.66
3015119	8717365183614	4.6	M36	DIN580-C15E-M36-4600KG	75	196	70	26	128	54	36	2.65