

## REMA 118 push trolley stainless steel

### Product information



### Properties

- Adjustable flange by adding or removing rings.
- Equipped with solid stainless steel wheels.
- Wheel rupture supports and tilt protection provide extra safety.
- Stainless steel AISI-304.

... [Read more](#)

**Material:** AISI-304

**Marking:** According to standard, CE-marked

**Standard:** EN 12100, EN 13157

## REMA 118 push trolley stainless steel

### Blueprint

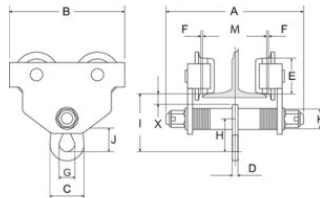

### Technical data

Part code	GTIN No.	WLL kg	Beam width mm	Model	Minimum radius mm	A mm	B mm	C mm	D mm	E mm	F mm	G mm	H mm	I mm	J mm	X mm	K mm	Weight kg
0922101	8717365177897	500	50-152	118-500	900	244	200	50	8	55	1.5~3.5	24	52.5	111	32	34	30	9.5
0922103	8717365177903	1,000	64-203	118-1000	1,000	310	246	62	10	68	1.5~3.5	30	67	138	40	39.5	40	13